

Code	Colour
BR	Black
BN	Brown
RD	Red
OG	Orange
YL	Yellow
GN	Green
BL	Blue
WT	White
GY	Grey
WH	White
PK	Pink

Cable designation
AWD35 - OG - 1
Cable marking
Cable colour (Change)
Conductor area mm ²

Dns.	Pos.	Description
C9	E 7	Connector, 15-pole
C14	E 7	Connector, 15-pole
C28	E 5	Socket, 2-pole, 24V outlet
C29	D 2	Connector, 25-pole, Inp-Roof
C41	A 5	Junction block
C55	B 4	Supply feed through
C78	D 3	Connector, 21-pole In-Floor
C180	E 0	Socket, 2-pole, 12/24V Outlet
C203	B 4	Splice, POW
C281	E 4	Connector, 15-pole
C273	B 8	Connector, 21-pole
C407	E 3	Socket, 2-pole, 24V outlet
E34	F 4	Voltage converter
F22	C 4	Fuse holder, 8-pole
G1	E 8	Joint connector, ground
G2	E 8	Joint connector, ground
G3	E 8	Joint connector, ground
G4	F 8	Joint connector, ground
G5	E 7	Joint connector, ground
G5	D 1	Joint connector, ground
G8	E 2	Joint connector, ground
G9	B 7	Joint connector, ground
G9	B 7	Joint connector, ground
G10	B 7	Ground, roof
G10	B 8	Ground, roof
G12	E 7	Ground, all-central unit
G13	E 6	Ground, torpedo wall
G14	F 8	Ground, torpedo wall
G15	E 6	Ground, torpedo wall
G16	A 8	Ground, roof
G20	B 3	Ground, cab front
G30	B 3	Ground, frame
G32	A 5	Ground, frame
G48	E 2	Ground, floor
M1	A 4	Starter motor
P1A	A 5	Battery
P1B	A 5	Battery
P2	D 4	Central electric unit
R92	D 2	Relay, delayed shut off

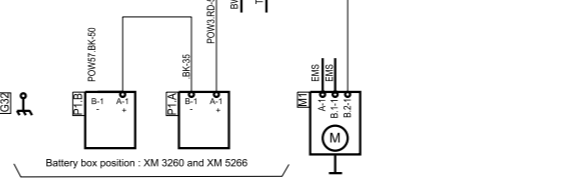
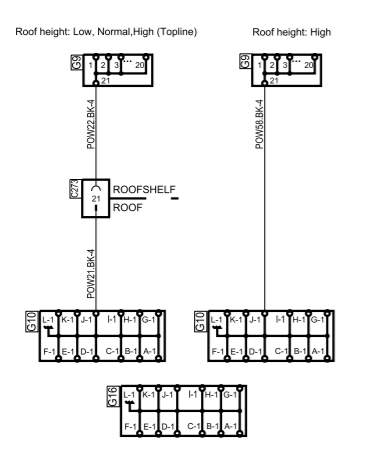

For connection with battery master switch service see sheet 2.
 For connection with battery master switch safety see sheet 3.
 For connection with battery bypass see sheet 4.
 For connection 12V for SLA see sheet 5.

STD 4247

SCANIA

Circuit Diagram:

POW

Drawing No.-
Sheet-Rev: **1395800-1-28**

N.B. The copyright and ownership of this drawing including associated computer data are and will remain ours. They must not be copied, used or brought to the attention of any third party without prior permission (C) Scania, Sweden