

Code	Colour
BR	Brown
BL	Blue
GR	Green
OR	Orange
PK	Pink
RD	Red
WH	White
YL	Yellow

Code	Description
C9	E 7 Connector, 15-pole
C14	E 7 Connector, 15-pole
C28	E 5 Bracket, 2-pole, 24V outlet
C29	D 3 Connector 21-pole, 120V Roof
C41	A 5 Junction block
C55	B 4 Supply lead through
C78	D 3 Connector 21-pole IP-Floor
C180	E 5 Socket, 3-pole, 120V Outlet
C261	E 4 Connector, 15-pole
C203	B 4 Splice, POW
C273	B 8 Connector, 21-pole
C407	E 3 Socket, 3-pole, 24V outlet
E34	F 4 Voltage converter
F22	C 4 Fuse holder, 8-pole
G1	E 8 Joint connector, ground
G2	E 8 Joint connector, ground
G3	E 8 Joint connector, ground
G4	F 6 Joint connector, ground
G5	E 7 Joint connector, ground
G6	D 1 Joint connector, ground
G8	E 2 Joint connector, ground
G9	B 7 Joint connector, ground
G9	B 7 Joint connector, ground
G10	A 7 Ground, roof
G10	A 8 Ground, roof
G12	E 7 Ground, el-central unit
G13	E 6 Ground, torpedo wall
G14	F 8 Ground, torpedo wall
G15	E 6 Ground, torpedo wall
G16	A 8 Ground, roof
G20	B 3 Ground, cab front
G30	B 3 Ground, frame
G32	A 5 Ground, frame
G48	E 2 Ground, roof
M1	A 4 Stair motor
P1.A	A 5 Battery
P1.B	A 5 Battery
P2	D 4 Central electric unit
R14	C 7 Relay, 15A
R20	C 6 Relay, 15B
R22	D 2 Relay, delayed shut off

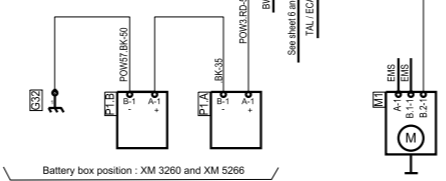
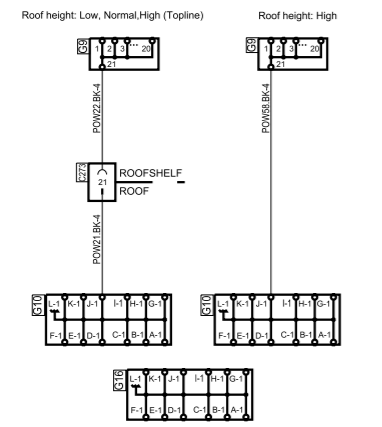

1) Only ADR trucks with Engine control unit S6

For connection with battery master switch service see sheet 2.

For connection with battery master switch safety see sheet 3.

For connection with battery bypass safety see sheet 4.

For connection 12V for SLA see sheet 5.

For connection with battery master switch safety and battery box position Rear frame end see sheet 6 and 7

STD 4247

**SCANIA**

Circuit Diagram:

## POW

Drawing No.- 1395800-1-34  
Sheet-Rev:

N.B. The copyright and ownership of this drawing including associated computer data are and will remain ours. They must not be copied, used or brought to the attention of any third party without prior permission (C) Scania, Sweden