

**SCANIA**

**08:06-05**

Issue 1 en

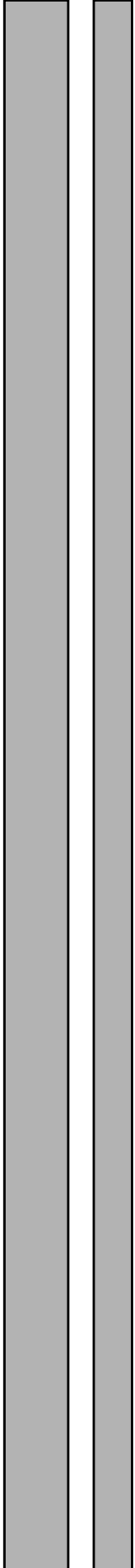

## Tag axle ASA1000D

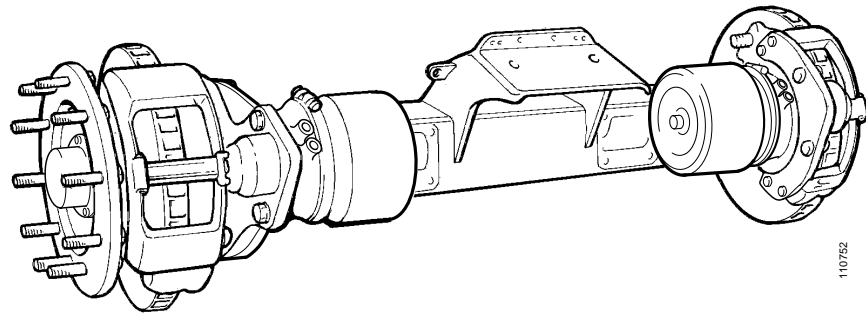

110752

# Tag axle ASA1000D

## General

ASA1000D is an air-sprung tag axle intended for a maximum axle pressure of 10 tonnes.

Tag axle ASA1000D consists of a welded square section using the hub for AD/ADA1300 without drive shaft and drive shaft housing. The brake components are also used in AD/ADA1300 with disc brake.

## Mounting

The axle mounting is identical to that of rear axle AD/ADA1300.

## Hub

For hub operations, refer to Disc brake hub, Rear axle, Work description.

When removing the hub, support mandrel 99 356 shall be used instead of plate 98 691.

## Brakes

For brake operations, refer to Disc brakes, Functional and Work description.

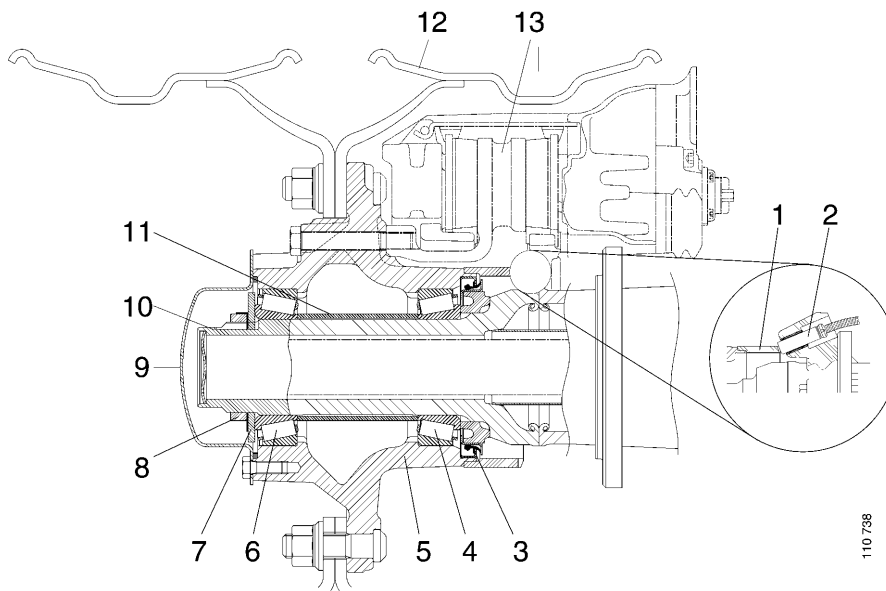

- |   |                      |    |                   |
|---|----------------------|----|-------------------|
| 1 | Toothed ring         | 7  | Protective washer |
| 2 | ABS sensor           | 8  | Axle nut          |
| 3 | Sealing ring         | 9  | Hub cap           |
| 4 | Inner roller bearing | 10 | Stub axle         |
| 5 | Hub                  | 11 | Spacer sleeve     |
| 6 | Outer roller bearing | 12 | Wheel             |
|   |                      | 13 | Brake disc        |