

SCANIA

08:06-04

Issue 1 en

Tag axle ASA700D

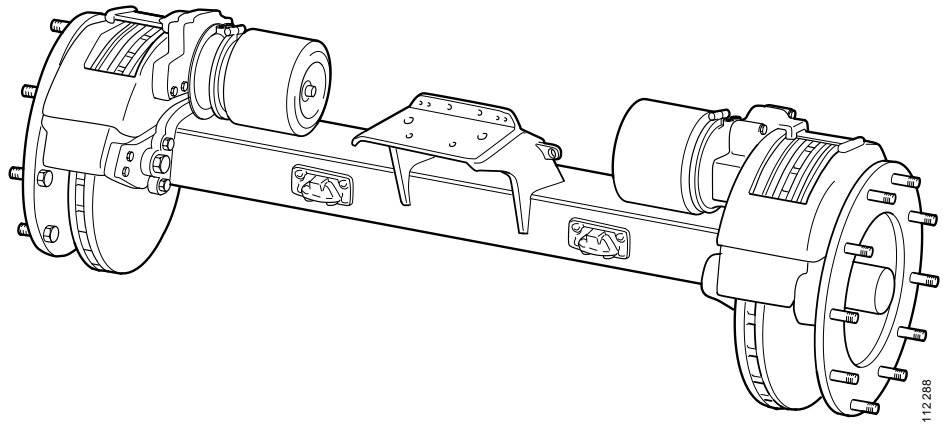

Tag axle ASA700D

General

ASA700D is an air-sprung tag axle intended for a maximum axle pressure of 7.5 tonnes.

The tag axle consists of a welded square section using the same basic hub as used in the front wheel hub. The brake components are also used in front axles with disc brakes.

Mounting

The axle mounting is the same as that used for the rear drive axle.

Hub

For hub operations, refer to Disc brake hub, Front axle, Work description.

Brakes

For brake operations, refer to Disc brakes, Functional and Work description.

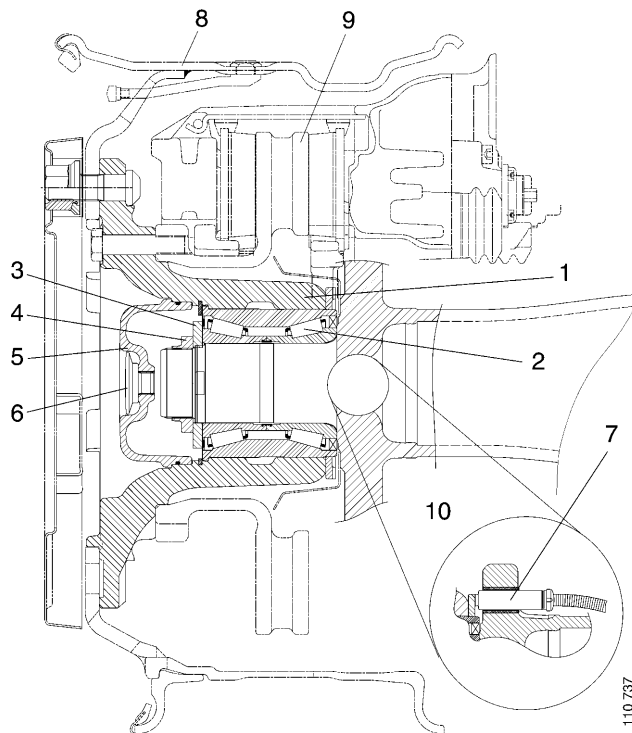

- | | | | |
|---|------------------|----|---------------|
| 1 | Hub | 6 | Plug |
| 2 | Bearing assembly | 7 | ABS sensor |
| 3 | Thrust washer | 8 | Wheel |
| 4 | Axle nut | 9 | Brake disc |
| 5 | Hub cap | 10 | Toothed wheel |