

SCANIA

18:01-01

Issue 4 **en**

Cab

Removal and fitting

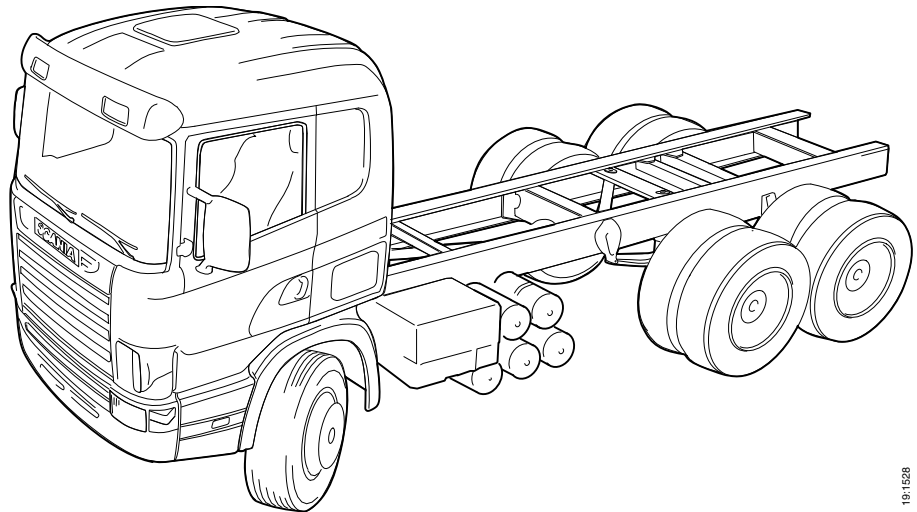

181528

Contents

Warnings, tilting the cab	3
Instructions, tilting the cab	4
Removing the cab	5
Fitting the cab	15

Warnings, tilting the cab



WARNING!

Working on the cab tilting mechanism disables the integral safety functions. Always follow the instructions and use the special tools specified. Otherwise there is a risk of the cab falling back and causing personal injury.

When the cab is tilted, the engine should be switched off, the parking brake should be applied and the gearbox should be in neutral.

If it is necessary to tilt the cab with the motor running, ensure that the gearbox is in neutral and that the gear lever in the cab can be moved freely.

No loose objects or heavy equipment should remain in the cab during tilting.

Do not tilt the cab if the ground slopes more than 10%.

Do not stand in front or behind the cab during tilting.

Always tilt the cab fully until it falls past the centre of gravity and into the end position.

Position the pump valve in the lowering position when the cab is fully tilted.

Always use a cab strut when working under the cab.

Instructions, tilting the cab

- 1 Apply the parking brake.
- 2 Set the gear lever in the neutral position.
- 3 Switch off the engine.
- 4 Remove all loose objects and heavy equipment from the cab.
- 5 Open the upper front grille panel.
- 6 Open the cab corners.
- 7 Close the doors.

IMPORTANT! Do not tilt the cab with the bumper removed. It is a part of the load bearing structure.

- 8 Turn the pump valve to the tilt position.
- 9 Tilt the cab until its own weight tips it forward to the end position. Continue to pump until the end position is reached, at which point resistance in the cab tilt pump increases.
- 10 When the cab is fully tilted, turn the pump valve to the lowering position.
- 11 Always use cab strut 99 295 or 99 431 when working under the cab. When the cab strut is no longer required, pump up the cab slightly to relieve and for removal of the cab strut pin.
- 12 Do not rest a hand on the mudguard seal when lowering the cab, as it may be trapped as the cab is lowered.
- 13 If the vehicle has concealed footsteps, ensure that the footstep covers are closed before lowering.

Removing the cab

Special tools

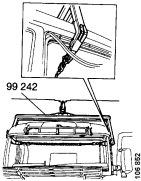
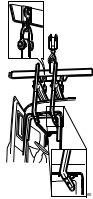
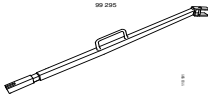
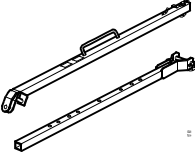
Number	Designation	Illustration	Tool board
99 242	Lifting tool	 <p>The illustration shows a close-up of a lifting tool (99 242) being used to lift a component. Below this is a larger view of the tool being used on the cab structure of a vehicle.</p>	-
99 441	Lifting tool	 <p>The illustration shows a complex lifting tool (99 441) with multiple arms and a central pivot point, designed for lifting heavy components.</p>	-
99 295	Cab strut, no key lock	 <p>The illustration shows a single cab strut (99 295) with a handle in the middle and mounting points at both ends.</p>	-
99 431	Cab strut	 <p>The illustration shows two cab struts (99 431) with handles and mounting points, similar to the previous one but with different end fittings.</p>	-

Description

- 1 **P and R cabs:** Open the upper front grille panel. Open the cab corners. Read "Warnings, tilting the cab" on page 3. Tilt the cab up completely as described in the cab tilting instructions on page 4. Fit cab strut 99 295 or 99 431.

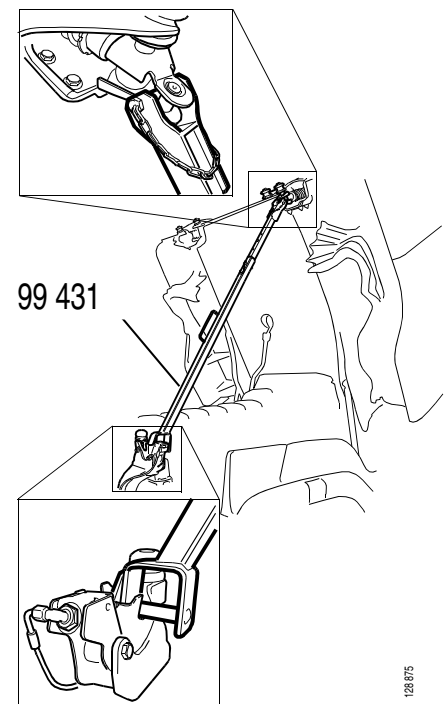
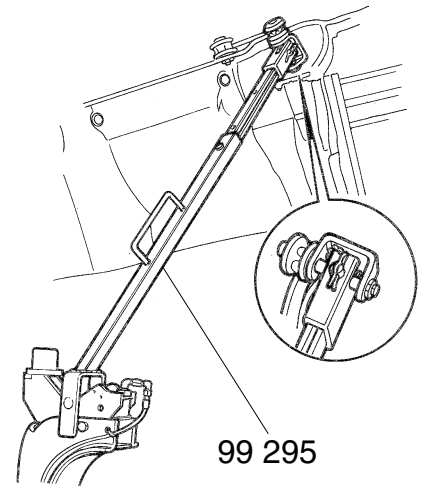

- 2 **Crew Cab:** Fit the accompanying cab struts. Read the driver's manual for full instructions.

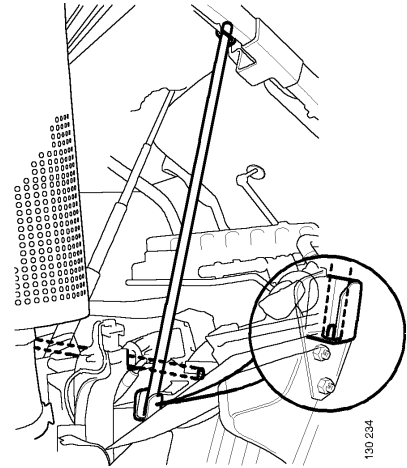

- 3 **Splinter-protected cab:** Fit the accompanying cab strut. Read the driver's manual for full instructions.

- 4 **P and R cab, Crew Cab and splinter-protected cab:** Disconnect the gearshift rod at the centre joint and place it to one side.

- 5 **P and R cab, Crew Cab and splinter-protected cab:** Remove the cab strut and lower the cab.

Note: Check that the gearshift rod is not broken or damages anything when the cab is lowered.

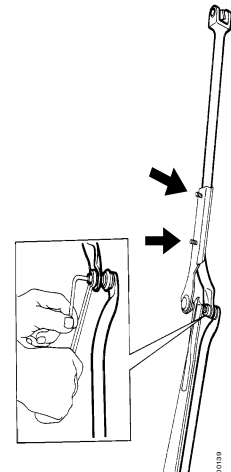

- 6 **T cab:** Disconnect the gearchange control at the forward ball joint on the gearshift rod.

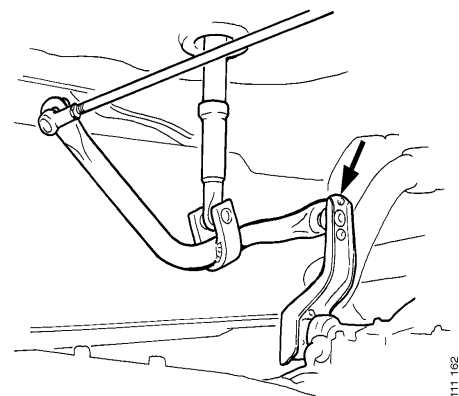

- 7 Disconnect one of the battery connections.
- 8 Evacuate the compressed air system.
- 9 Drain the cooling system. See Workshop Manual group 2, Cooling system.

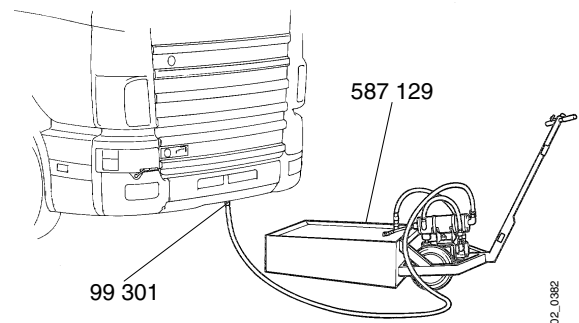

- 10 Drain the AC system. See Workshop Manual group 18, ETC/AC.
- 11 Disconnect the earth connections.
- 12 Disconnect the test connection bracket.
- 13 Disconnect the brake and electrical connections, including the bracket.
- 14 Disconnect the windscreen washer hose.

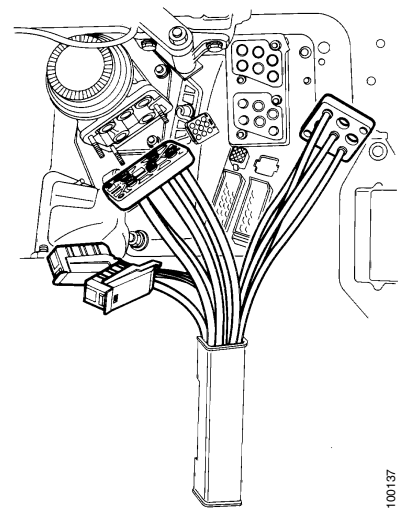

- 15 Disconnect the clutch fluid hose and fold it upwards to prevent the fluid in the reservoir from leaking out.
- 16 Plug the open hydraulic hose connections to avoid ingress of dirt into the hydraulic system.
- 17 Disconnect the slave cylinder bleeding hose and control hose. Fit protection plugs to the cylinder hose and pipe connections.

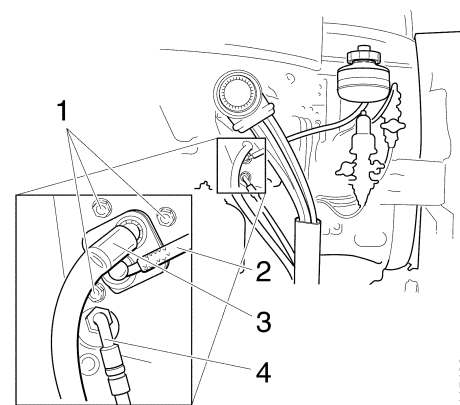

- 1 *Servomaster retaining nuts*
- 2 *Clutch fluid hose*
- 3 *Bleeder hose*
- 4 *Control hose*

18 Cab with four-point suspension:

Disconnect the air hoses to the forward air springs at the levelling valve.

19 Cab with four-point suspension:

Disconnect the rod to the levelling valve lever and remove the levelling valve.

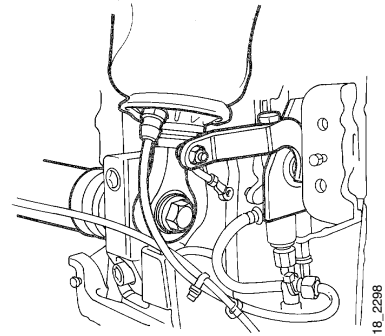

P and R cab with four-point suspension

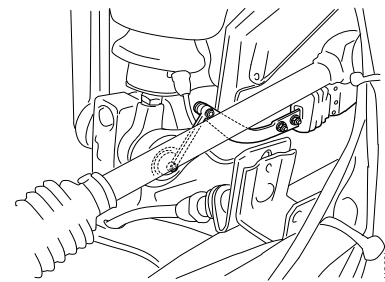

T cab with four-point suspension

20 Unscrew the clamp bolt and remove the lower steering wheel shaft universal joint from the steering gear input shaft.

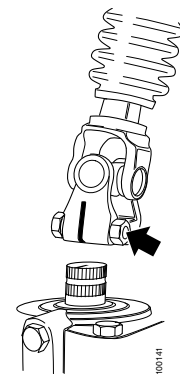

21 P and R cab and splinter-protected cab:

Disconnect the cab tilt stop from the upper bracket.

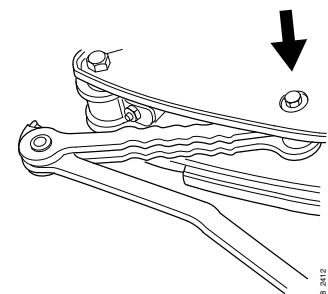

- 22 Disconnect all hoses from underneath the expansion tank and at the water valve.
- 23 Disconnect and plug the AC pipes at the dehydrator. See Workshop Manual group 18, ETC/AC.
- 24 Disconnect the water level sensor connector.

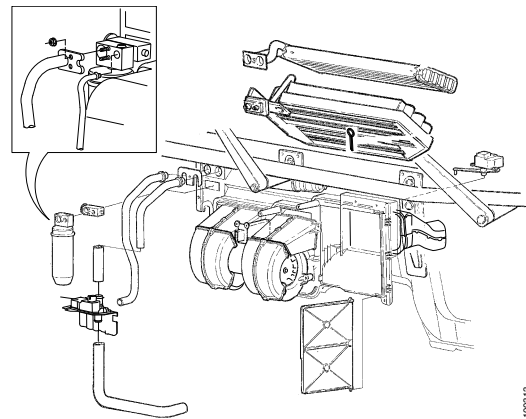

- 25 **P and R cab, Crew Cab and splinter-protected cab:** Disconnect the air intake bellows and plastic cover.

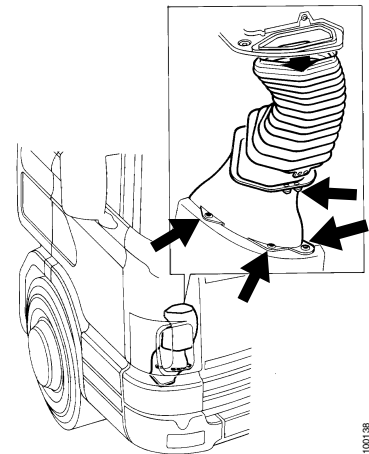

- 26 Remove the central electric unit covers.
- 27 Disconnect all the cables.
- 28 Remove the bolts securing the cable cluster.

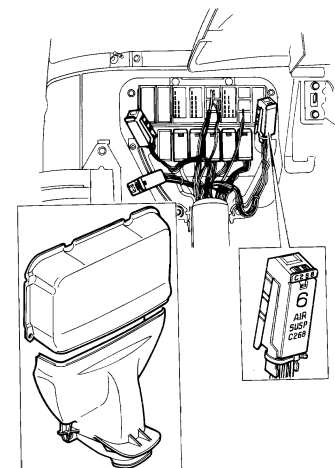



WARNING!

Ensure that no people are in the vicinity of a cab being lifted off or on.

- 29 Fit the lifting tool 99 242 and secure the lifting arms using a chain, as illustrated.
- 30 **Crew Cab and splinter-protected cab:** Use two lifting tools 99 242 with additional lifting balk 99 441 between.

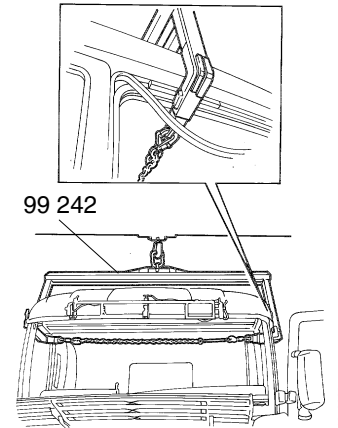

- 31 **P and R cab, Crew Cab and splinter-protected cab:** Pump using the cab tilt pump until the cab tilt lock releases.



WARNING!

If the cab does not hang horizontally, adjust at the door opening to achieve equilibrium when lifting the cab.

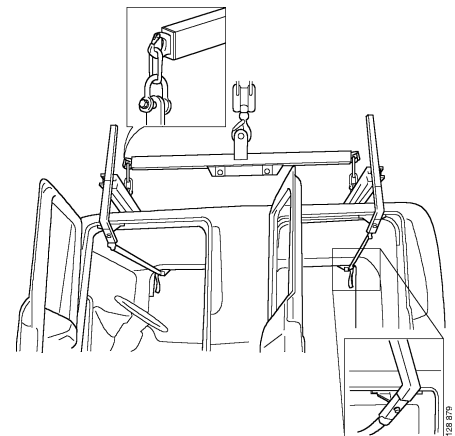

Crew Cab

- 32 Raise the overhead crane until the cab is supported by the lifting tool.

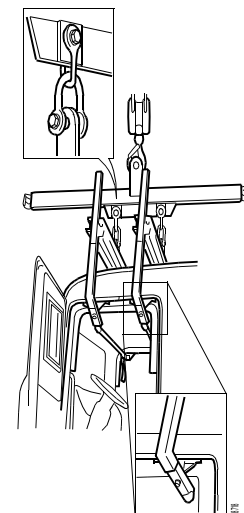

Splinter-protected cab

- 33 **P and R cab, Crew Cab and splinter-protected cab:** Disconnect the upper attachment of the cab tilt cylinder.

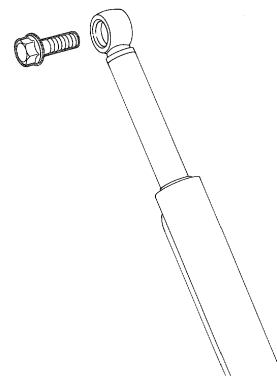

18_2397

- 34 **Cab with four-point suspension only:** Remove the caps on the anti-roll bar.

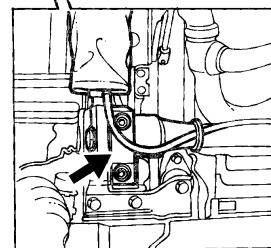
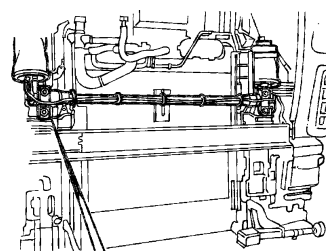

18_2338

P and R cab with four-point suspension

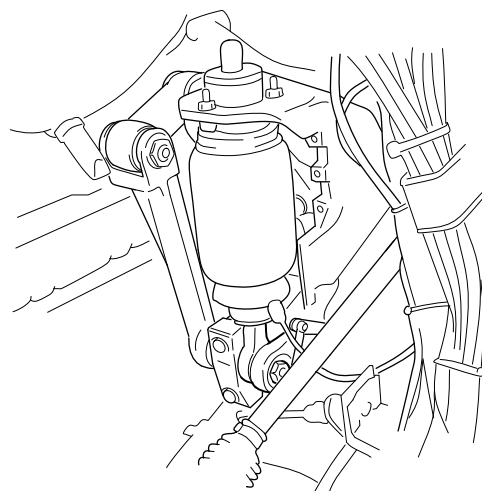

115 690

T cab with four-point suspension

35 Cab with two-point suspension: Remove the bolts for the front cab attachment.

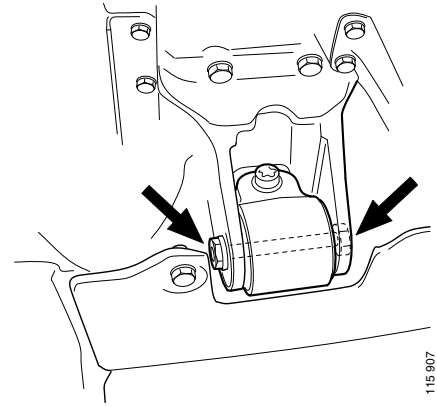

115 907

P and R cab with two-point suspension

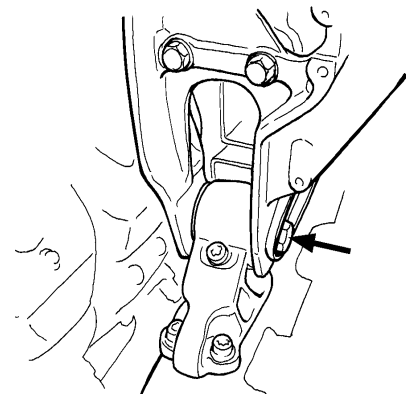

110 919

T cab with two-point suspension

36 P and R cab and Crew Cab: Remove the upper parts of the recirculation shields.

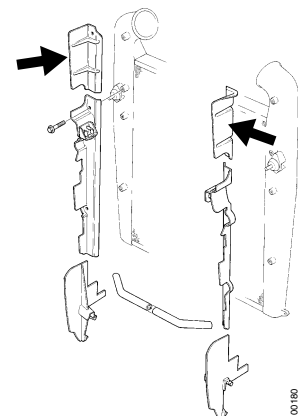

100 180

- 37 **T cab:** Remove the rear cab suspension fixing bolts.

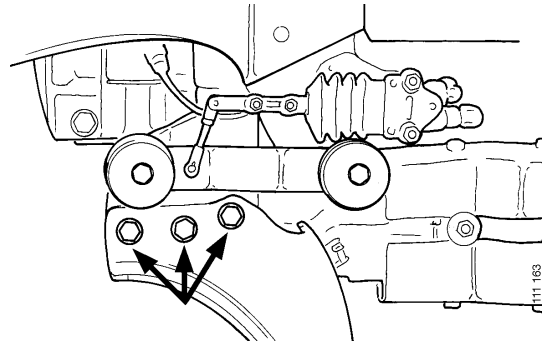

WARNING!

Ensure that no people are in the vicinity of a cab being lifted off or on.

- 38 Carefully lift the cab.
- 39 **P and R cab, Crew Cab and splinter-protected cab:** Suspend the gearshift rod from the front grille panel using a rope or similar item.
- 40 Lift off the cab.

Fitting the cab

Specifications

Tightening torques

Anti-roll bar: Cap	135 Nm
Two-point suspension: Cab attachment, front	190-240 Nm
Cab tilt cylinder: Upper bolt	270 Nm
Cab tilt stop: Upper bolt	270 Nm
Steering wheel shaft, universal joint: Clamp bolt	47 Nm

Special tools

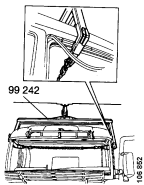
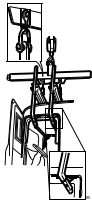
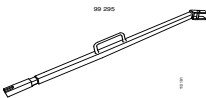
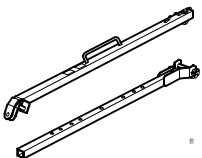
Number	Designation	Illustration	Tool board
99 242	Lifting tool	 The illustration shows a close-up of a lifting tool (99 242) being used on a vehicle's front suspension. A callout box labeled '99 242' points to the tool. Below it, a smaller diagram shows the tool's application on the front of a vehicle chassis.	-
99 441	Lifting tool	 The illustration shows a lifting tool (99 441) being used on a vehicle's front suspension. It consists of a long horizontal bar with a hook and a handle.	-
99 295	Cab strut, no key lock	 The illustration shows a single cab strut (99 295) with a handle and a mounting eye.	-
99 431	Cab strut	 The illustration shows two cab struts (99 431) with handles and mounting eyes.	-

Description

- 1 Fit the lifting tool 99 242 and secure the lifting arms using a chain, as illustrated.

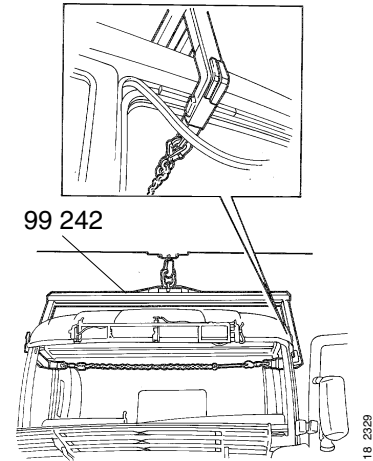

- 2 **Crew Cab and splinter-protected cab:** Use two lifting tools 99 242 with additional lifting balk 99 441 between.
- 3 Lift the cab into position.
- 4 Carefully lower the cab.

Note: P and R cab, Crew Cab and splinter-protected cab: Check that the gearshift rod is not broken or damages anything.

- 5 Lower the cab further and align it in the brackets.

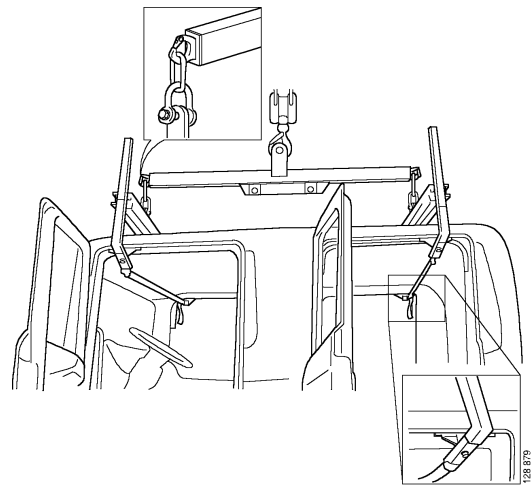

Crew Cab

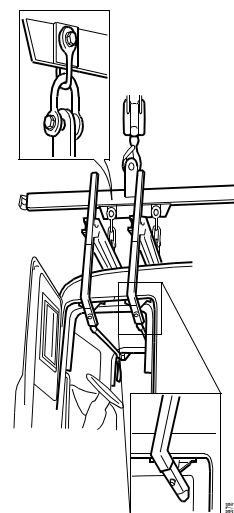

Splinter-protected cab

- 6 **Cab with four-point suspension:** Fit the caps using four new bolts. Tighten the bolts to 135 Nm.

IMPORTANT! Always use new bolts for the caps.

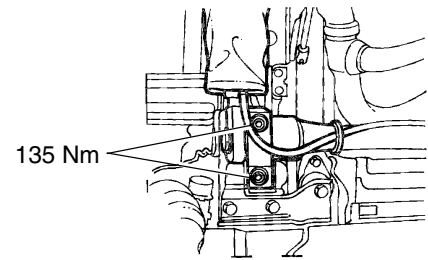

P and R cab with four-point suspension

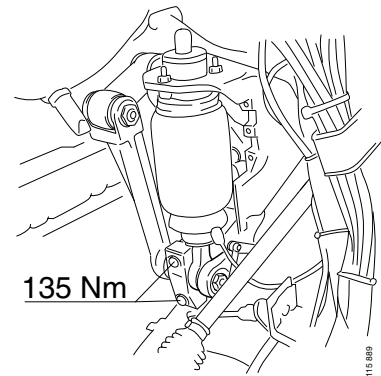

T cab with four-point suspension

- 7 **Cab with two-point suspension:** Fit the bolts for the front cab attachment and tighten to 190-240 Nm.

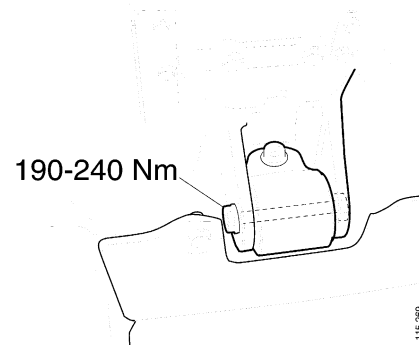

P and R cab with two-point suspension

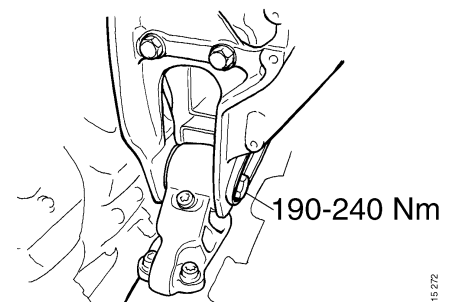

T cab with two-point suspension

- 8 **T cab:** Fit the rear cab suspension fixing bolts.

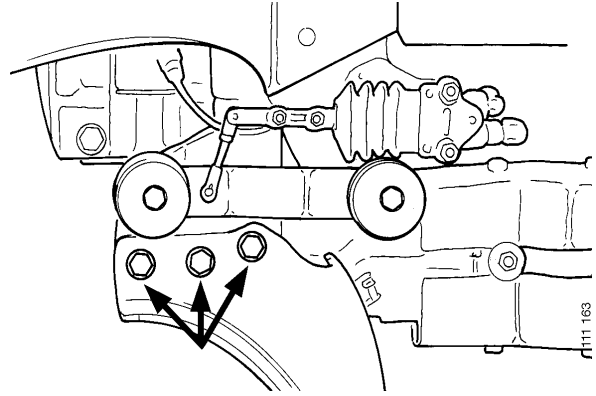

- 9 **P and R cab, Crew Cab and splinter-protected cab:** Align the cab tilt cylinder upper bolt and tighten to 270 Nm.

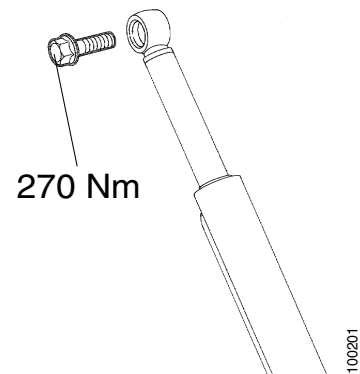

- 10 **P and R cab and splinter-protected cab:** Fit the upper part of the cab tilt stop and tighten to 270 Nm.

- 11 Remove lifting tool 99 242.

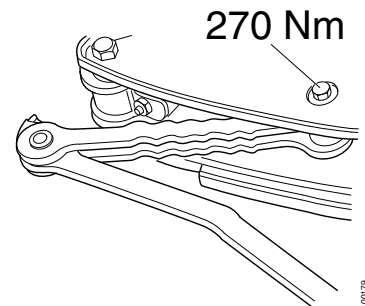

- 12 Position the wheels in the straight-ahead position so that the marking on the input shaft also points straight forward. Fit the universal joint so that the marking on the joint matches the marking on the input shaft. Tighten the clamp bolt to 47 Nm.

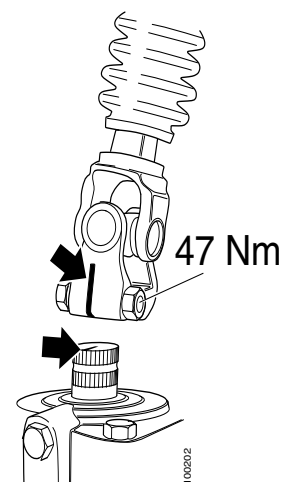

- 13 Fit the brake connections and electrical connections, including the earth connection and the bracket. Also fit the bracket with test connections.

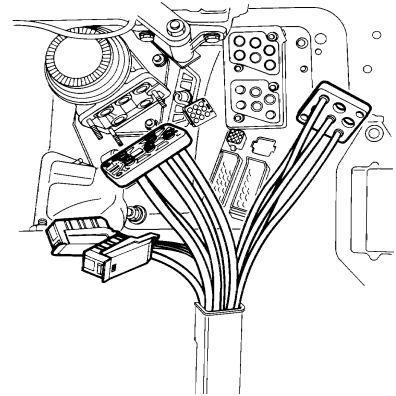

- 14 Connect the windscreen washer hose.

- 15 Fit the bleeding hose, clutch fluid hose and control hose.

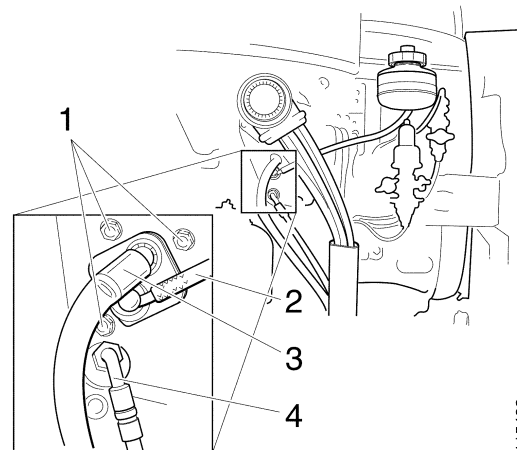

b115433

- 1 *Servomaster retaining nuts*
- 2 *Clutch fluid hose*
- 3 *Bleeder hose*
- 4 *Control hose*

- 16 **Cab with four-point suspension:** Fit the levelling valve and link for the front air springs.
- 17 **Cab with four-point suspension:** Connect the hoses from the air springs to the levelling valve.

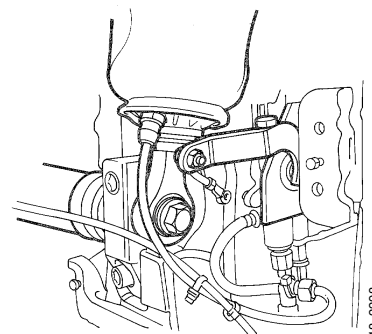

P and R cab with four-point suspension

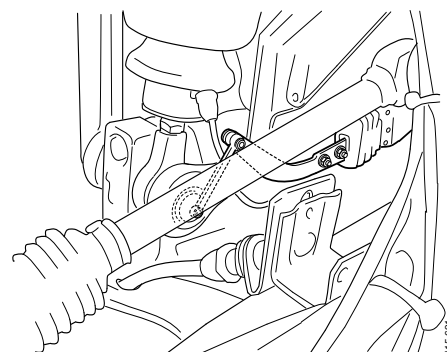

T cab with four-point suspension

- 18 Connect the electrical cables to the central electric unit.
- 19 Fit the bracket for the cable cluster and the covers.

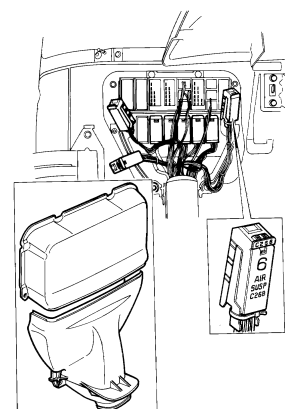

- 20 **P and R cab and Crew Cab:** Fit the upper parts of the recirculation shields.

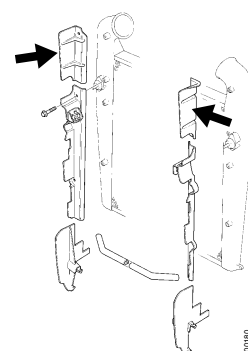

- 21 **P and R cab, Crew Cab and splinter-protected cab:** Fit the plastic cover and air intake bellows.
- 22 Connect the cooling system hoses. See Workshop Manual group 2, Cooling system.
- 23 Fit the water level sensor connector.
- 24 Connect the AC pipes. Fit a new receiver dryer. See Workshop Manual group 18, ETC/AC.

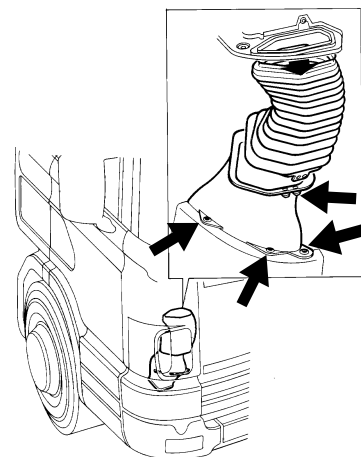

100138

- 25 **P and R cabs:** Read Warnings, tilting the cab. Tilt the cab completely as indicated in the cab tilting instructions. Fit cab strut 99 295 or 99 431.

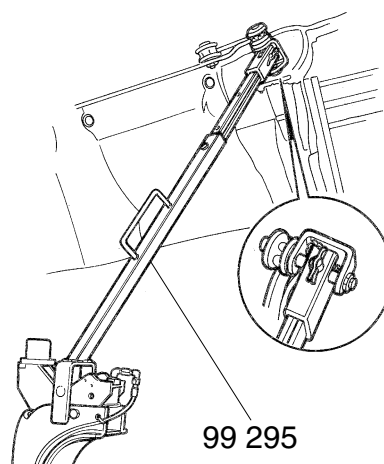

99 295

18 2021

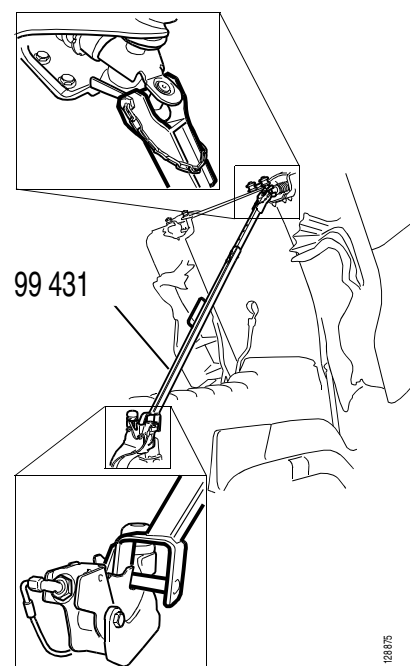

99 431

18 875

26 **Crew Cab:** Fit the accompanying cab struts.
See the driver's manual for full instructions.

27 **Splinter-protected cab:** Fit the accompanying cab strut. See the driver's manual for full instructions.

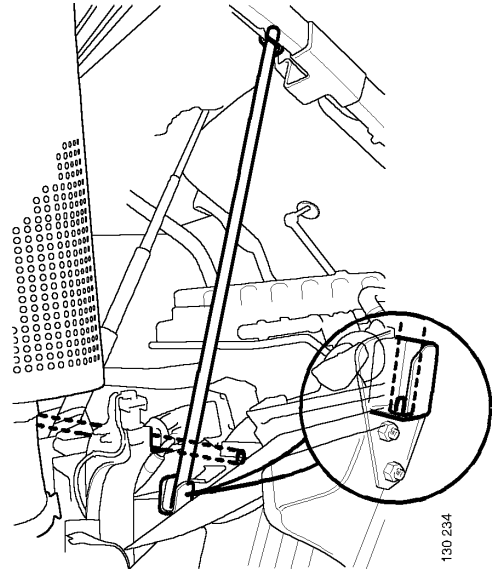

28 **P and R cab, Crew Cab and splinter-protected cab:** Connect the gearshift rod at the centre joint.

29 **P and R cab, Crew Cab and splinter-protected cab:** Remove the cab strut. Lower the cab.

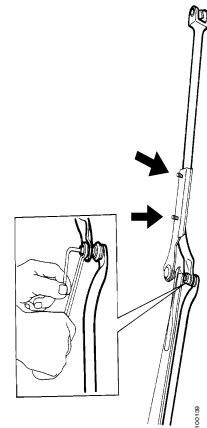

30 **T cab:** Connect the gearchange control ball joint.

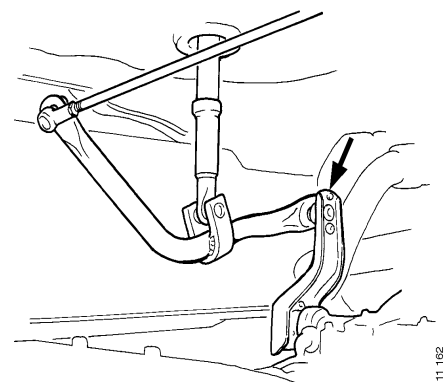

-
- 31 Connect the batteries.
 - 32 Fill the compressed air system with air.
 - 33 Fill the clutch with fluid and bleed.
 - 34 **Cab with four-point suspension:** Check the drive level of the front air springs according to Workshop Manual group 18, Cab suspension.
 - 35 Check the drive level on the rear air springs as described in Workshop Manual group 18, Cab suspension.



WARNING!

Danger of crushing when adjusting drive level.

- 36 Fill the cooling system. See Workshop Manual group 2, Cooling system.
- 37 Fill the AC system. See Workshop Manual group 18, ETC/AC.
- 38 Check the compressed air system, the cooling system and the AC system for leakage.
- 39 Check that the electrical equipment operates correctly.
- 40 Check the gear lever position.

