

SCANIA

18:01-03

Issue 2 en

Door, window and rear view mirrors

Work Description

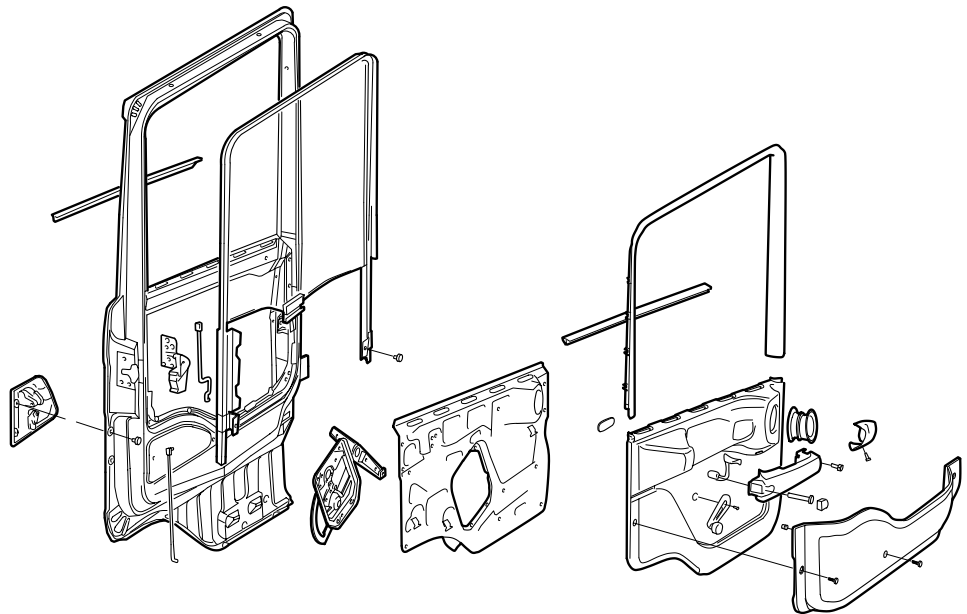

Contents

Removal

Removing the lock, R and T cabs.....	3
Removing the lock, P cab.....	4
Renewing the lock cylinder.....	5
Renewing the lock sleeve and latch spring.....	6
Renewing levers.....	7
Renewing rear view mirror glass.....	8
Renewing the door stop.....	9
Removing the door, part by part.....	11
Removing the window.....	15
Removing the door, complete.....	16

Fitting

Fitting the lock, R and T cabs.....	17
Fitting the lock, P cab.....	18
Fitting the door, part by part.....	19
Fitting the window.....	23
Fitting the door, complete.....	24

Work Description

Removing the lock, R and T cabs

- 1 Remove the door handle by undoing the two screws on the inside of the door.
- 2 Remove the link rod in the rear edge of the door handle, turn 90° (see illustrations for right and left doors) and detach the pull rod.

Note: Carefully prise off the pull rod and link rod.

- 3 Remove the screws for the lock in the end plate on the door.

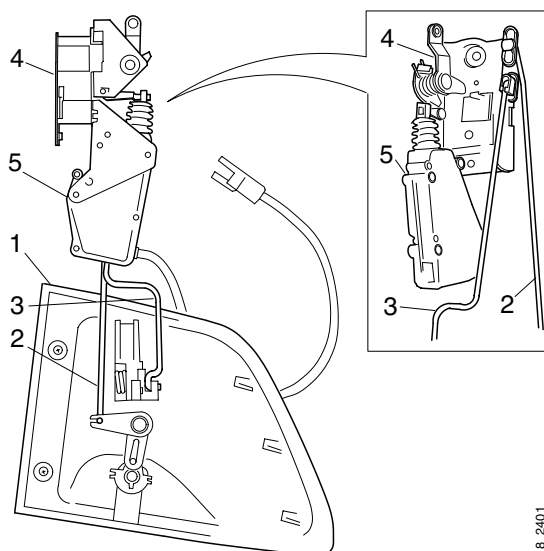

18_2401

- 4 Prise out the lock.
- 5 Unscrew the central locking motor from the lock.

- 1 *Door handle*
- 2 *Link rod*
- 3 *Pull rod*
- 4 *Lock*
- 5 *Central locking motor*

When renewing the central locking motor, the door panel must be removed in order to gain access to the joint in the electrical cable.

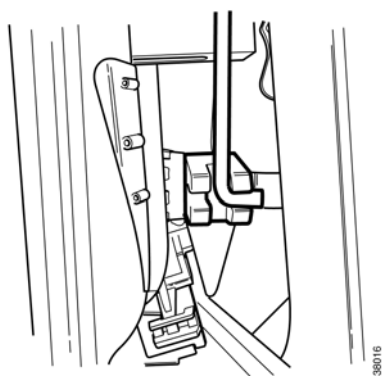

139016

Link rod - left door

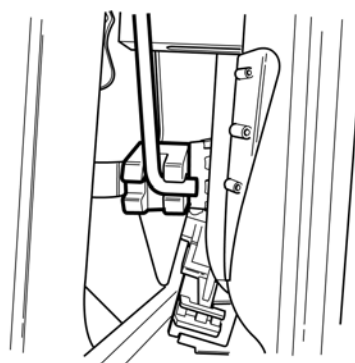

139015

Link rod - right door

Removing the lock, P cab

- 1 Refer to Removing the door, part by part.
Go through steps 1-15.
- 2 Remove the screw securing the guide rail in
the outer edge of the door.

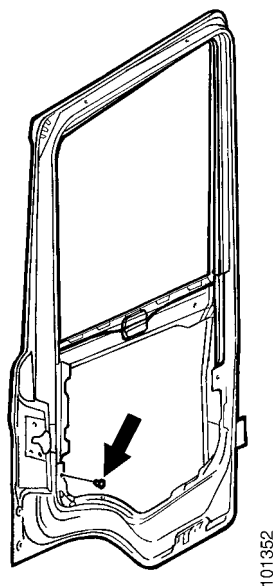

- 3 Hold the guide rail to one side and pull out
the lock and central locking motor along the
edge of the door.

Note: Be careful not to break the guide rail at
the top outer corner.

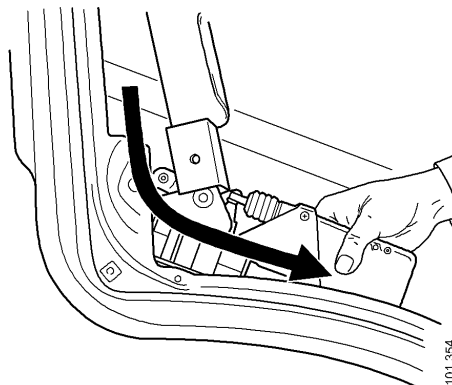

Renewing the lock cylinder

- 1 Remove the door handle from the door.
- 2 Insert the key in the lock.
- 3 Prise the latch spring apart using a screwdriver.

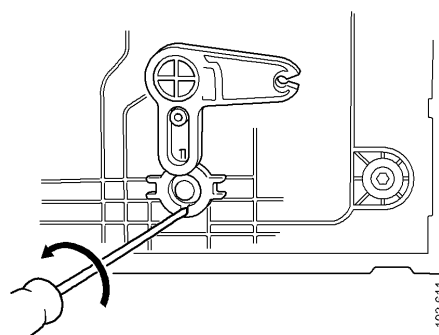

- 4 Press out the lock cylinder.

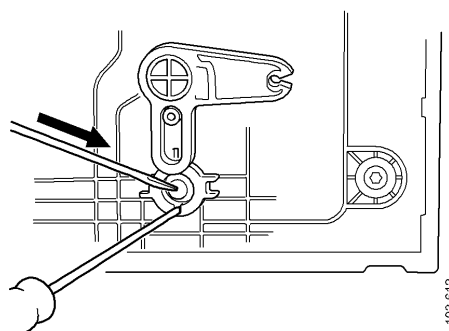

- 5 Pull out the lock cylinder. Insert the key into the new lock cylinder and push it in.

Note: The key must remain in the lock cylinder until the lock cylinder is refitted in the handle. Otherwise the buckle tongues and springs may fall out.

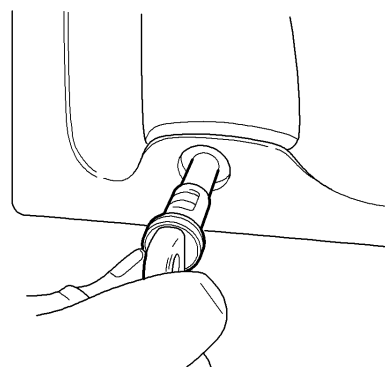

Note: Check that the latch spring engages with the lock cylinder.

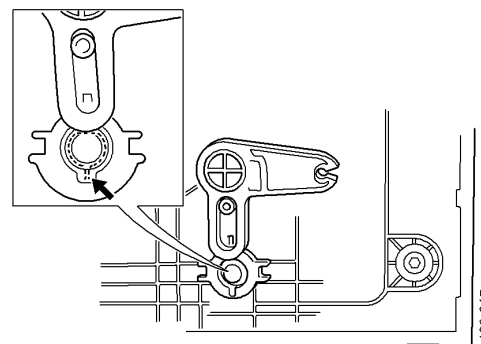

Renewing the lock sleeve and latch spring

- 1 Remove the lock cylinder. Refer to Renewing the lock cylinder.

Note: The key must remain in the lock cylinder until the lock cylinder is refitted in the handle. Otherwise the buckle tongues and springs may fall out.

- 2 Bend out the plastic rims so that the lock sleeve comes loose.

Note: Take care not to break off the plastic rims.

- 3 Fit the new latch spring in the new lock sleeve.
- 4 Press in the lock sleeve. Make sure that the plastic rims are held in position.

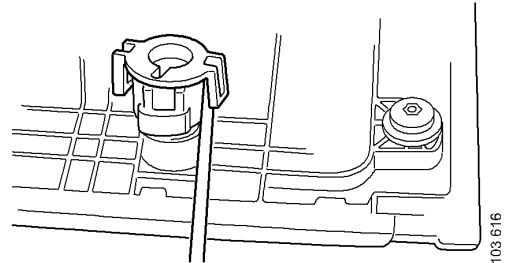

- 5 Press in the lock cylinder.

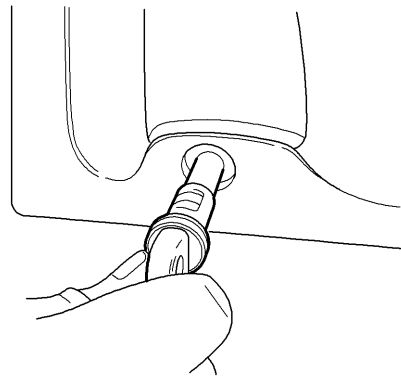

Note: Check that the latch spring engages with the lock cylinder.

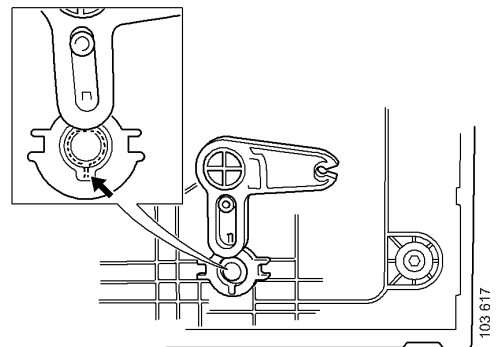

Renewing levers

- 1 Prise off the retaining lug using a screwdriver. Pull up the lever.
- 2 Press in the new lever.

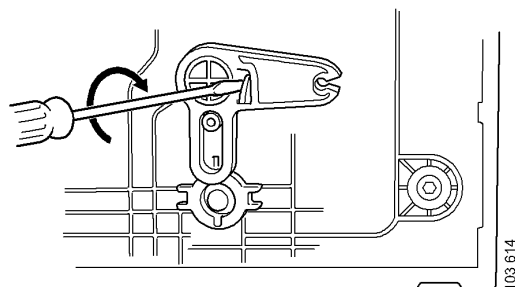

Key function lever

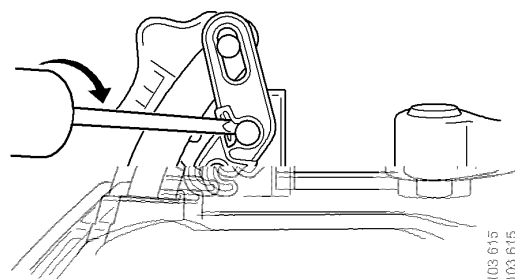

Door opening lever

Renewing rear view mirror glass

- 1 Angle the mirror glass in order to gain access to the latch spring on the rear.

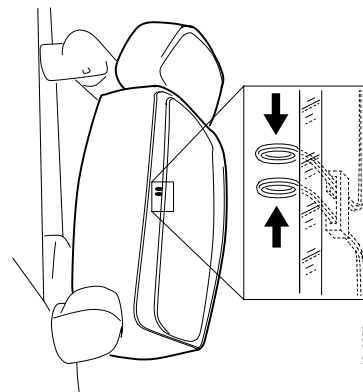

- 2 Detach the electrical connection to the mirror glass.
- 3 Fit the parts in reverse order.

Note: Check that the latch spring is engaged.

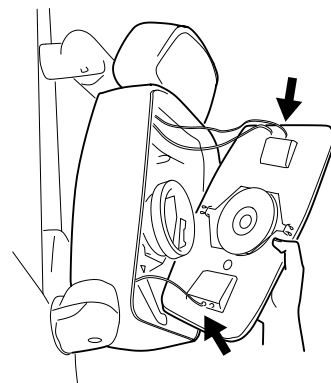

Renewing the door stop

Old door stop

- 1 Open the door half way (approximately 40 degrees).
- 2 Remove the locking clip and pin.
- 3 Press in the door stop arm
- 4 Remove the grommet.
- 5 Remove the additional mat and kick strip.
- 6 On the driver side: Remove the casing under the steering wheel and the casing covering the steering column.
- 7 On the driver side: Fold back the casing with the exhaust brake switch.
- 8 Unscrew the door stop and pull out the door stop arm through the hole in the floor pan.

Fit the door stop in reverse order.

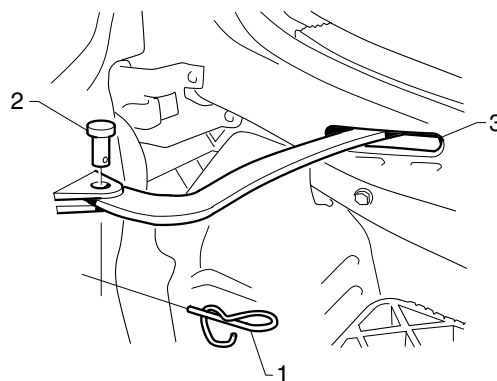

100667

- 1 *Locking clip*
- 2 *Pin*
- 3 *Grommet*

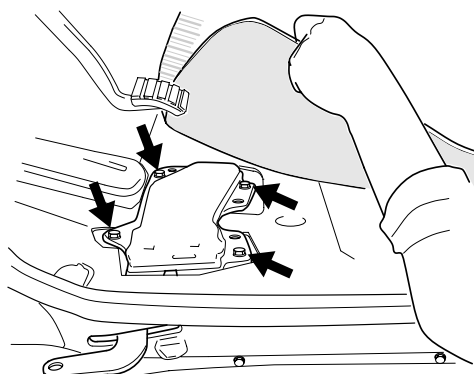

100677

New door stop

- 1 Open the front and side covers. (The bonnet if it is a T cab).
- 2 Open the door fully.
- 3 Undo the screws in the door.
- 4 Undo the nuts on the A-pillar (3 off).

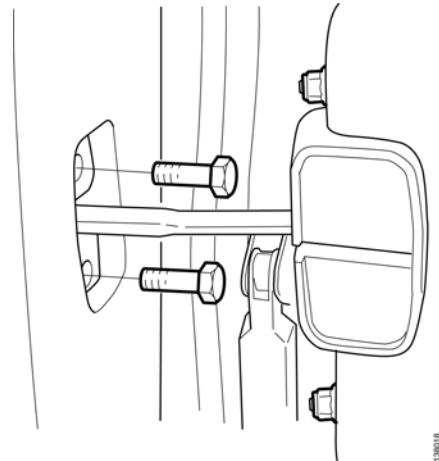
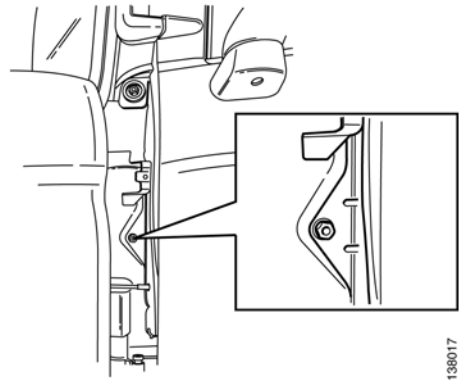

- 5 Fold away the mat on the wall.
- 6 Remove the door stop and pull the stop arm out through the hole by turning the arm half a turn.

Fit the door stop in reverse order.

Removing the door, part by part

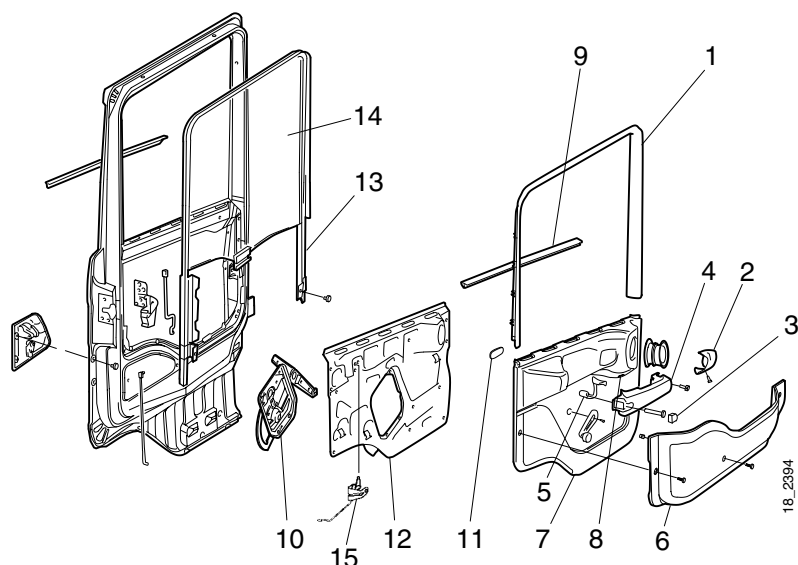

- | | | | |
|---|------------------|----|-----------------------|
| 1 | Frame | 9 | Scraper strip |
| 2 | Switch panel | 10 | Electrical connection |
| 3 | Blanking piece | 11 | Blanking piece |
| 4 | Armrest | 12 | Door panel |
| 5 | Handle | 13 | Guide rail |
| 6 | Door pocket | 14 | Window |
| 7 | Inner door panel | 15 | Door opening link |
| 8 | Boarding lamp | | |

- 1 Remove the frame from around the window, starting at the upper edge.
- 2 Remove the screw in the lower edge of the switch panel for the window winder. Unplug the electrical connection.
- 3 Remove the door pocket.
- 4 Remove the blanking piece, armrest and handle.
- 5 Remove fuse number 15 for cab lighting and central locking.

- 6 Remove the boarding lamp and pass it through the hole in the door panel.
- 7 Remove the scraper strip.
- 8 Remove the door panel. Lift it up and out.
- 9 Manufacture a hook and use it to suspend the window, or use vacuum cups or a strap.
- 10 Wind the window almost fully up. Place the small hook under the window behind the panel. Suspend the large hook on the upper edge of the door. Lower the window until it is suspended on the hook or strap.

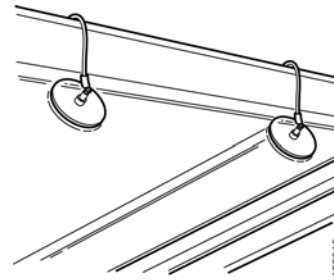
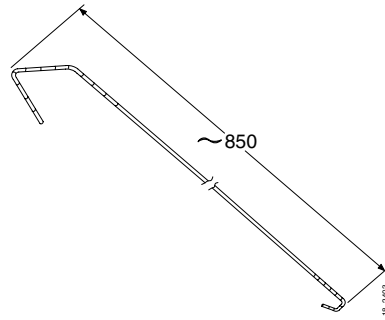

- 11 Disconnect the electrical connector for the window winder motor.

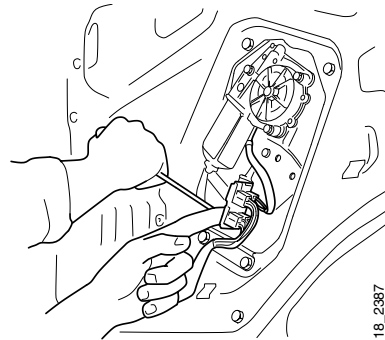

- 12 Detach the arm from the window winder motor through the hole behind the blanking piece.

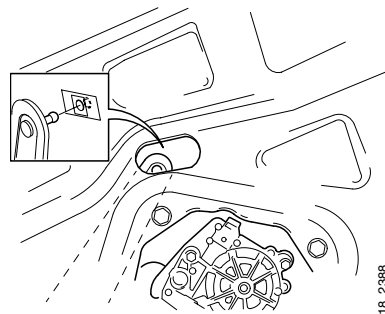

- 13 Remove the door opening link.

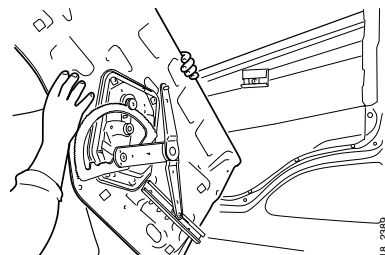

- 14 Remove the door panel.
- 15 Unplug the electrical connection for the central locking.

Removing the rear view mirrors

- 16 Remove the cover from the lower bracket on the rear view mirror.



- 17 Undo the lower bracket and unplug the electrical cable.

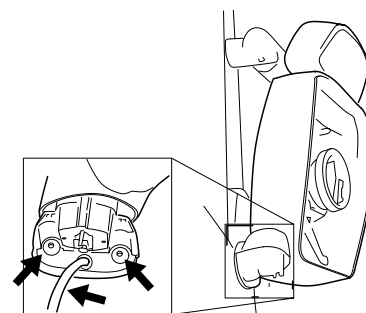

- 18 Undo the upper bracket and remove the rear view mirrors.

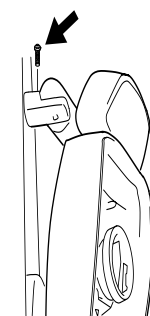

- 19 Remove the entire cable cluster from the door.

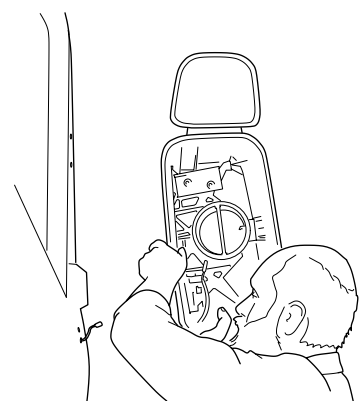

- 20 Remove the guide for the step in the lower edge of the door.

- 21 Remove the cab corner gas damper and fold the cab corner forwards.

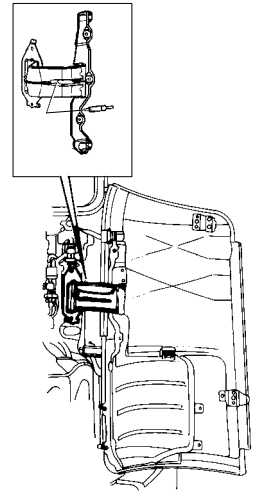

- 22 Remove the door stop attachment from the door. Refer to *Renewing the door stop*.
- 23 Use an overhead hoist and attach the door using a lifting strap.

Note: Take care not to damage the frame around the window.

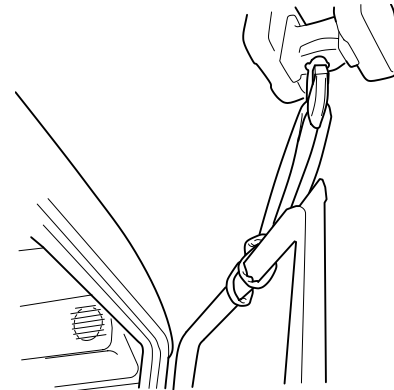

- 24 Remove the covers from the upper door hinge.
- 25 Remove the cover strip from the A-pillar.

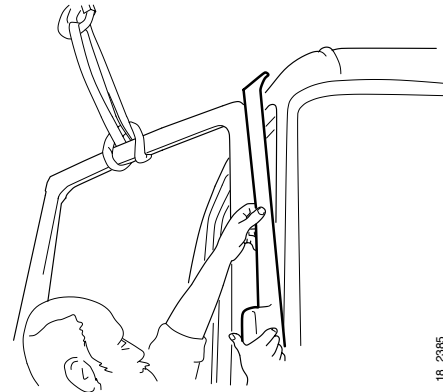

- 26 Remove the door pins using a hammer and drift.
- 27 Lift the door with the overhead hoist.

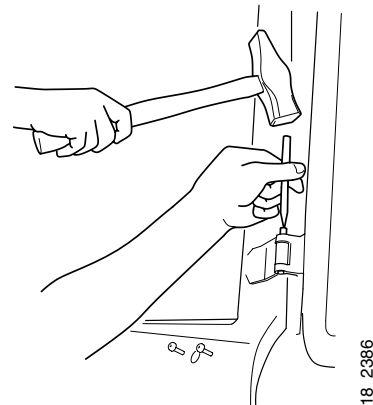

Removing the window

- 1 See page 11, Removing the door, part by part. Go through steps 1-14.
- 2 Drill out the pop rivets in the window guide rail, and remove the screws in the lower edge.
- 3 Remove the hook, suction cups or strap holding the window.
- 4 Lift out the guide rail and window.

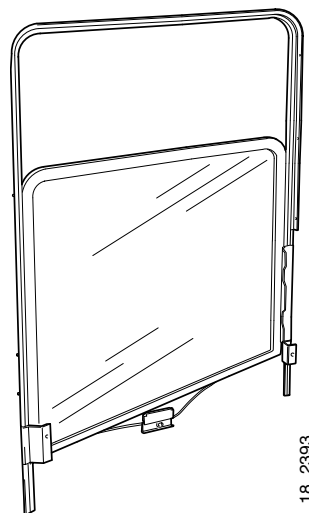

18 2393

Removing the door, complete

- 1 Lower the window about 1 dm.
- 2 Remove the cover under the instrument panel.
- 3 Unplug the electrical connector in the A-pillar.
- 4 Prise away the cable grommet and pull out the cable cluster.
- 5 Remove the door stop attachment from the door. Refer to *Renewing the door stop*.
- 6 Use an overhead hoist and attach the door using a lifting strap.

Note: Take care not to damage the frame around the window.

- 7 Remove the covers from the upper door hinge.
- 8 Remove the cover strip from the A-pillar.

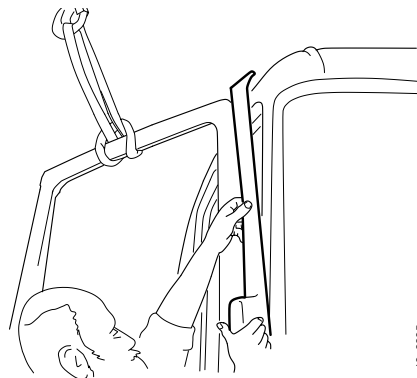

- 9 Remove the door pins using a hammer and drift.
- 10 Lift the door with the overhead hoist.

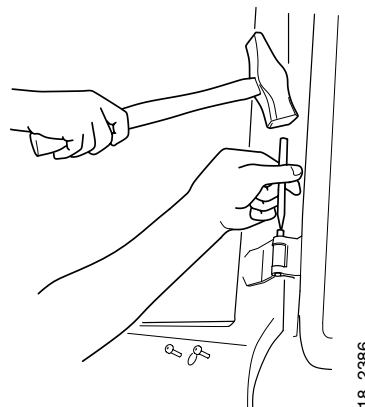

Fitting the lock, R and T cabs

- 1 Fit the central locking motor onto the lock.

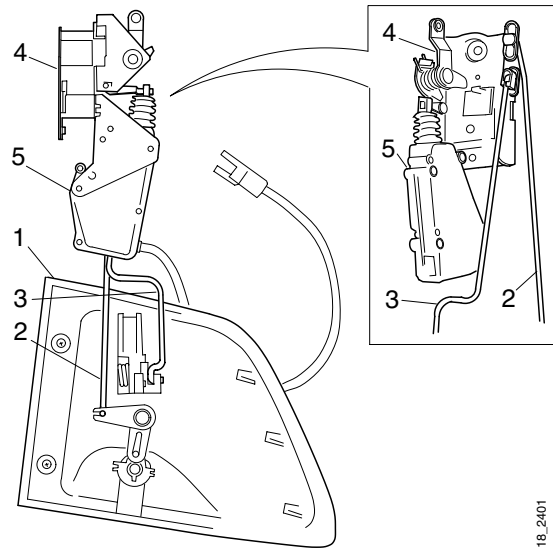

18_2401

- 1 Door handle
- 2 Link rod
- 3 Pull rod
- 4 Lock
- 5 Central locking motor

- 2 Fit the lock in the door end plate.
- 3 Fit the pull rod and link rod in the door handle and screw in place. (See illustrations for right and left doors).

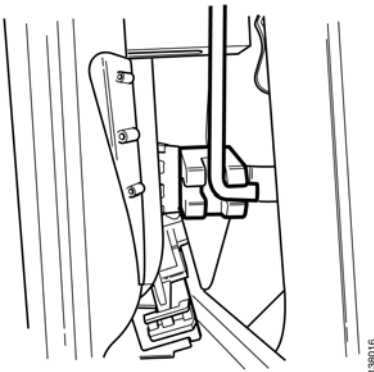

138016

Link rod - left door

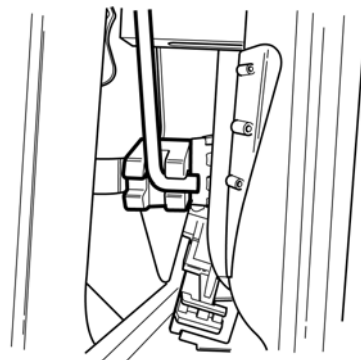

138015

Link rod - right door

Fitting the lock, P cab

- 1 Hold the guide rail to one side and pull out the lock and central locking motor along the edge of the door.

Note: Be careful not to break the guide rail at the top outer corner.

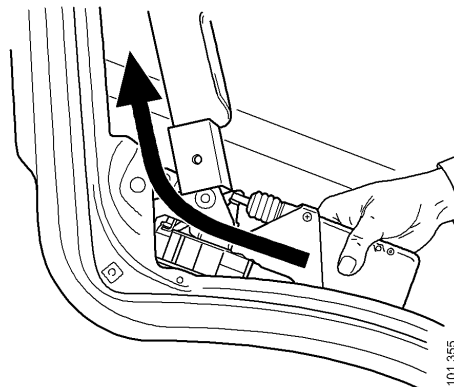

- 2 Fit the screw securing the guide rail in the outer edge of the door.

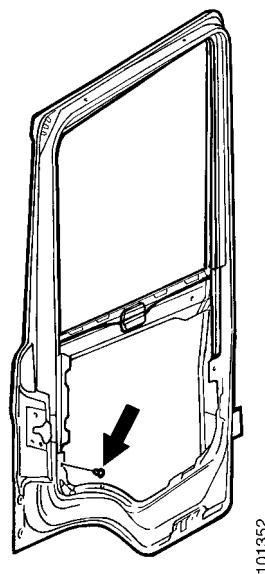

- 3 Refer to Fitting the door, part by part. Go through steps 7-20.

Fitting the door, part by part

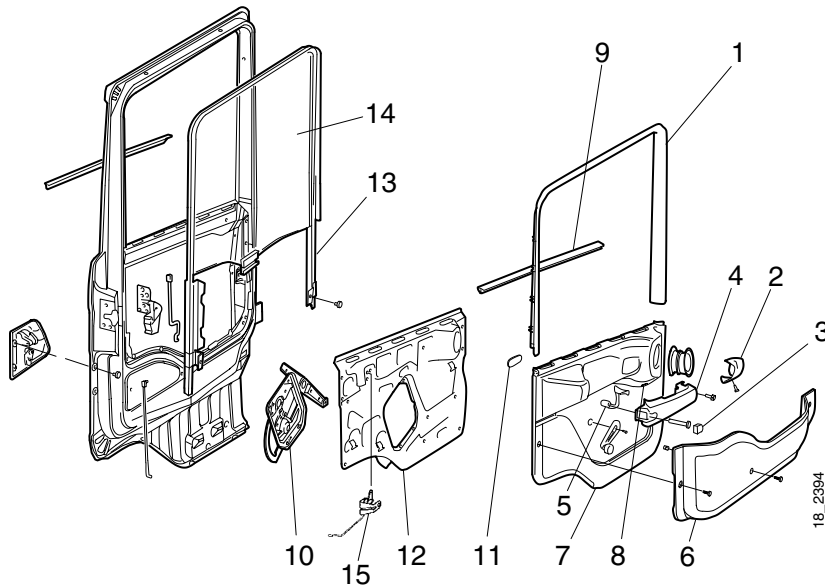

- | | | | |
|---|------------------|----|-----------------------|
| 1 | Frame | 9 | Scraper strip |
| 2 | Switch panel | 10 | Electrical connection |
| 3 | Blanking piece | 11 | Blanking piece |
| 4 | Armrest | 12 | Door panel |
| 5 | Handle | 13 | Guide rail |
| 6 | Door pocket | 14 | Window |
| 7 | Inner door panel | 15 | Door opening link |
| 8 | Boarding lamp | | |

- 1 Lift the door into position using the overhead hoist.
- 2 Using a hammer, knock the pins through the door hinges.

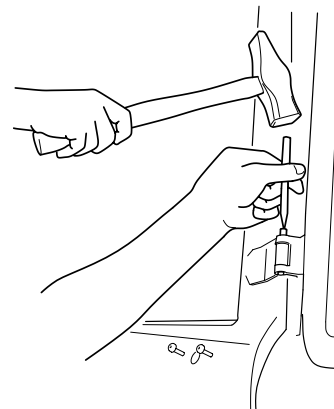

- 3 Fit the cover strip to the A-pillar.
- 4 Fit the cover on the upper hinge.

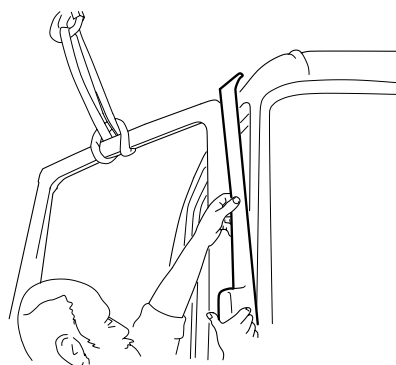

18 23845

- 5 Fit the door stop attachment in the door.
Refer to Renewing the door stop.
- 6 Fit the cab corner gas damper.

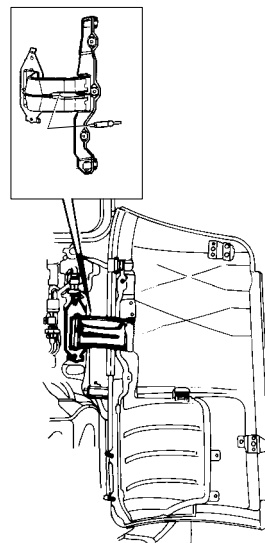

100289

- 7 Fit the guide for the step in the lower edge of the door.
- 8 Pull the cable through the door and connect it to the central locking system.
- 9 Fit the door panel, align the arm with the window winder motor and fit the blanking piece.
- 10 Remove the hook, suction cups or strap from the window.
- 11 Fit the door opening link.
- 12 Fit the electrical connection to the window winder motor.

- 13 Temporarily connect the switch panel and check that the window moves easily in the guide rail.
- 14 Thread the boarding lamp through the hole in the door panel and fit the door panel.
- 15 Screw the boarding lamp in place.
- 16 Fit the handle, armrest and blanking piece.
- 17 Fit the scraper strip and door pocket.
- 18 Connect the switch panel to the window winder and screw on the switch panel.
- 19 Fit the frame around the window.
- 20 Fit fuse number 15 for cab lighting and central locking.

Fitting the rear view mirrors

- 21 Fit the rear view mirrors, connect the electrical cable, screw on upper and lower brackets.

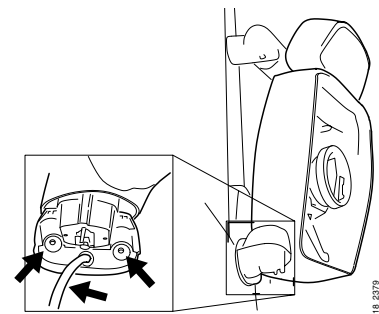
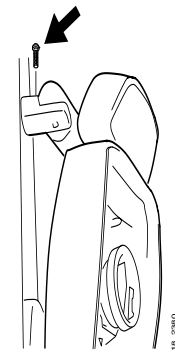
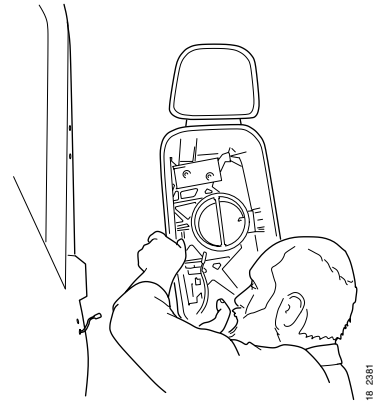

- 22 Fit the cover to the lower bracket on the rear view mirror.



Fitting the window

- 1 Align the window in the guide rail (see illustration on page 19).
- 2 Align the window and the guide rail in the door.
- 3 Fit the hook, suction cups or strap on the window. Lower the window into the space.
- 4 Pop rivet the guide rail to the door. Start with the upper holes.
- 5 Raise the window and attach the hook or strap.
- 6 Screw in the screws in the lower edge of the guide rail.
- 7 See page 19, Fitting the door, part by part. Go through steps 7-20.

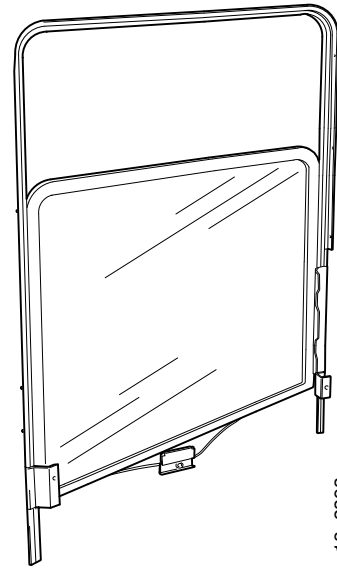

18 2393

Fitting the door, complete

- 1 Lift the door into position using the overhead hoist.

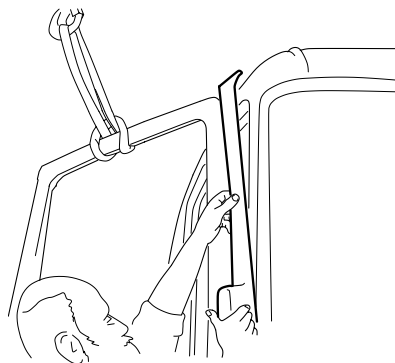

- 2 Using a hammer, knock the pins through the door hinges.
- 3 Fit the cover strip to the A-pillar.
- 4 Fit the plastic covers on the upper hinge.

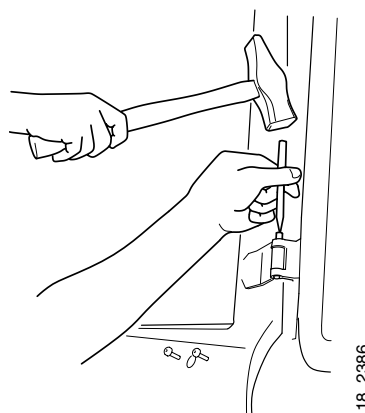

- 5 Fit the door stop attachment in the door. Refer to Renewing the door stop.
- 6 Pull the cable cluster through the door pillar and fit the cable grommet.
- 7 Connect the electrical connector in the A-pillar.
- 8 Fit the cover under the instrument panel.