

SCANIA

19:03-13

Issue 2 en

Fleet Analysis System 1

Installation and function description

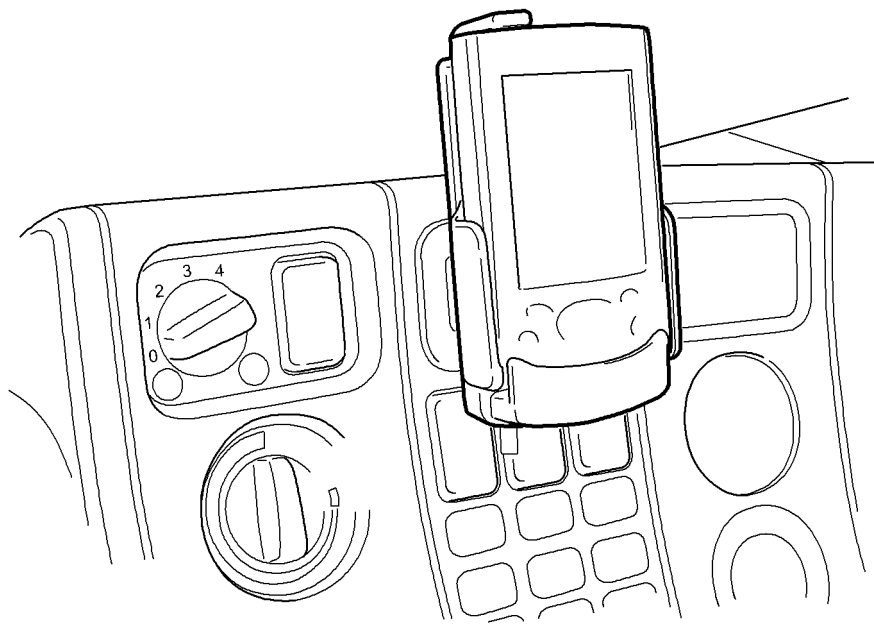

1285519

Installation

The holder of the portable computer should be placed in panel D, see arrow 1.

- Detach panels D,E,F.
- Set the outlet air control 2, in the middle position and remove it from the instrument panel.
- If there is a diagnostic switch panel, it can be moved from panel D to panel F.
- Pull the wiring through panel D and attach the holder of the portable computer in the panel. Pull the wiring from the instrument panel to the central electric unit.
- Connect according to the figure and the diagram.

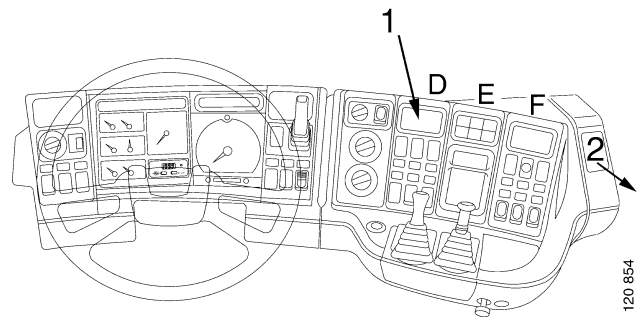

Note: Connector C461 is not connected but is clamped to the existing wiring underneath the central electric unit.

For registration of power take-off operation (PTO) in the portable computer program, it is necessary to ensure that the EDC control unit or the co-ordinator receives a control signal. Refer to the booklet for the EDC system or the co-ordinator, 16:07-10, for connecting the control signal.

Function

Scania portable computer works in the same way as Scania trip computer regarding fault codes and when communicating with the vehicle.

Refer to booklet *17:01-03, Trip computer*, under sections General information and List of fault codes for information about vehicle communication.

Refer to Driver's manual *Fleet Analysis System - Fleet settings & Tripp Analyser*, for information about the program functions of the portable computer

Support

Contact your local distributor for support on the portable computer software and hardware and the statistics program Scania Fleet.

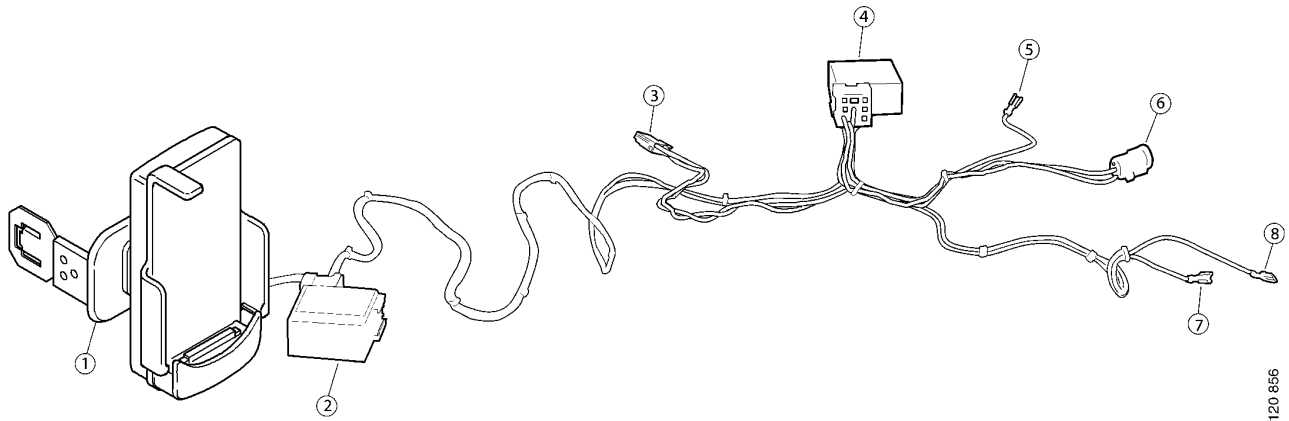

120 856

- 1 Holder
- 2 Adapter/ E52
- 3 C56/CAN1
- 4 FMS Interface/ E51
- 5 31-G10, Black
- 6 C461
- 7 30H-F2/40A, Red
- 8 15XG-F2/45B, Grey

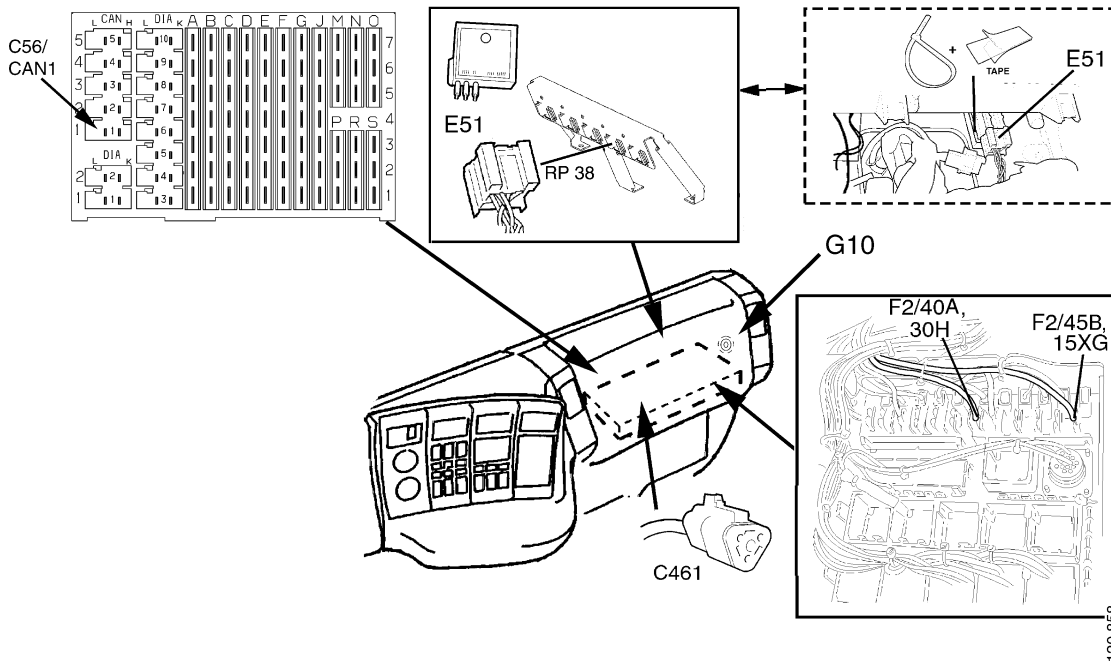

120 856

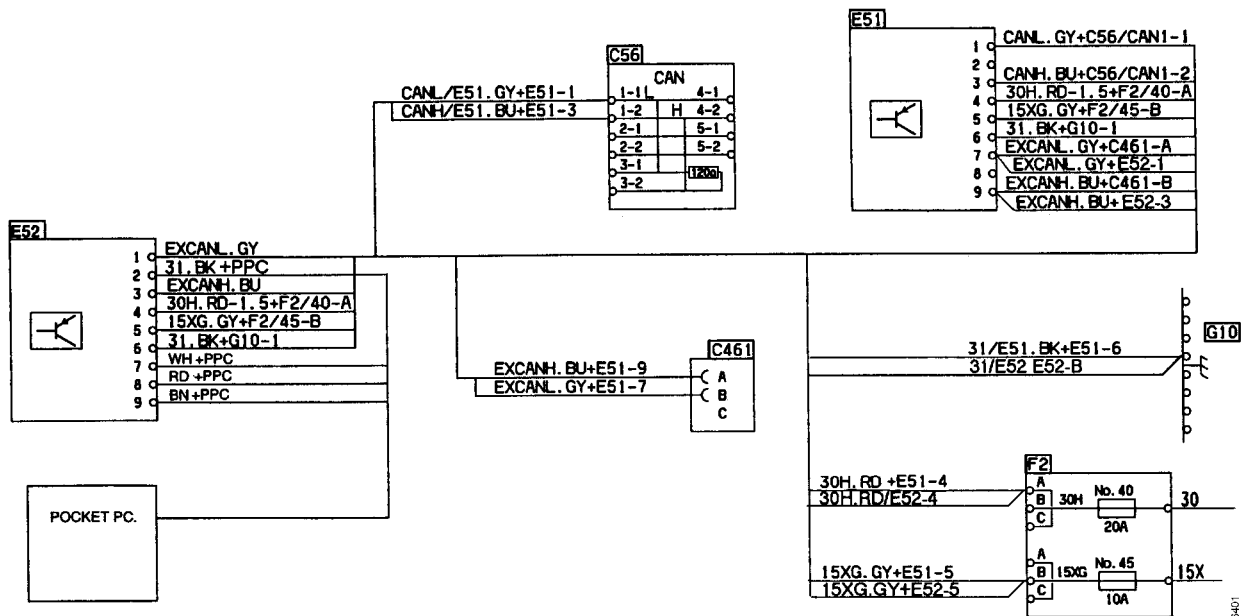

120 8401

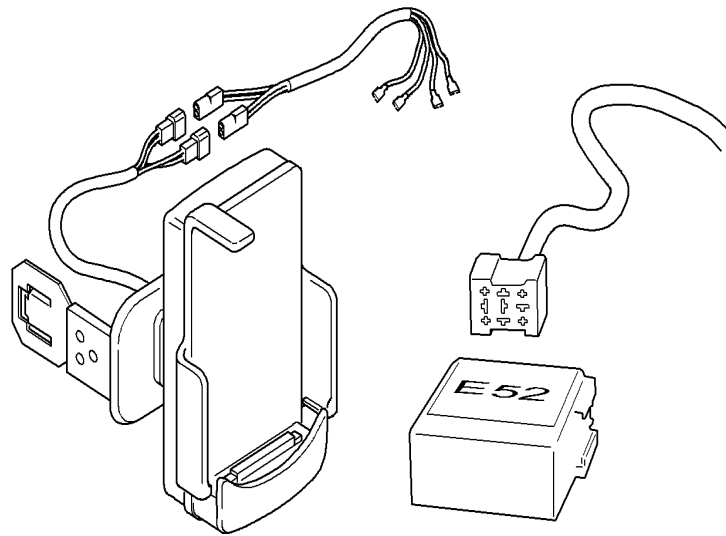

121236

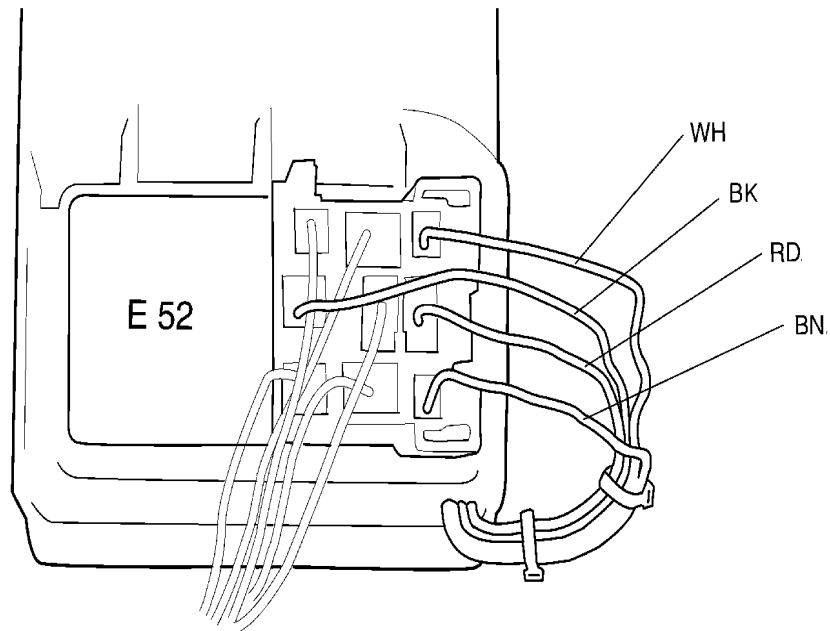

121 234

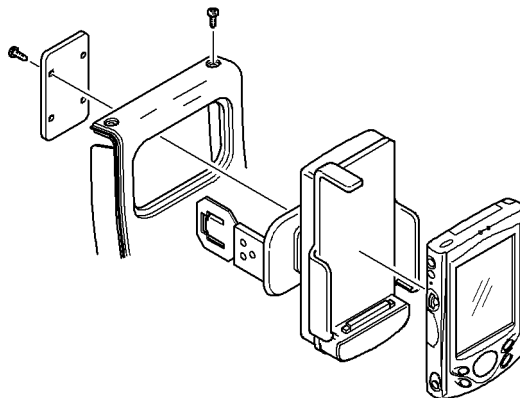

120347